

2025 OWNER HANDBOOK GLADIATOR



Jeep[®]



Vehicle images are for illustration purposes only. Actual products sold may vary.



1

INTRODUCTION
Page 4



2

INTERIOR
Page 9

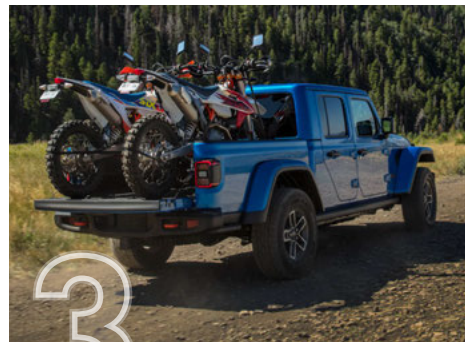

3

EXTERIOR
Page 29



4

EMERGENCY
Page 33



5

SPECIFICATIONS
Page 42

Jeep®

6

INDEX
Page 46

INTRODUCTION

OWNER HANDBOOK INTRODUCTION	4
SYMBOLS KEY	4
IF YOU NEED ASSISTANCE	5
ARGENTINA	5
AUSTRALIA	5
BALANCE OF THE CARIBBEAN	5
BOLIVIA	5
BRAZIL	5
CHILE	6
CHINA	6
COLOMBIA	6
COSTA RICA	6
DOMINICAN REPUBLIC	6
ECUADOR	6
EL SALVADOR	6
EUROPE	6
GUATEMALA	7
HONDURAS	7
INDIA	7
JAPAN	7
NEW ZEALAND	7
PANAMA	7
PARAGUAY	8
PERU	8
PUERTO RICO AND U.S. VIRGIN ISLANDS	8
REUNION	8
SOUTH AFRICA	8
TAIWAN	8
URUGUAY	8
VENEZUELA	8

INTERIOR

INTERIOR OVERVIEW	9
STARTING AND OPERATING	10
Keyless Enter 'n Go™ — Passive Entry	10
Stop/Start System	10
MULTIMEDIA & PHONE CONNECTIVITY	11
Uconnect System	11
Uconnect Settings	11
Pair/Delete A Device	11
Apple CarPlay®	12
Android Auto™	12
Uconnect Voice Recognition	12
Off-Road Pages	13
CHARGING & OUTLETS	13
Electrical Power Outlets	13
Power Inverters — If Equipped	14
USB/AUX Control	14
INSTRUMENT CLUSTER	15
Getting To Know Your Instrument Cluster	15
Instrument Cluster Display Location	
And Controls	16
Warning Lights And Messages	16
INTERIOR COMFORT SETTINGS	17
Climate Controls	17
Automatic Climate Control Descriptions	
And Functions	17
Automatic Temperature Control (ATC)	18
Climate Voice Recognition	18
Front Heated Seats — If Equipped	18

Power Front Seats Adjustment — If Equipped	19
Head Restraints	19
LIGHTING OPERATION	20
Headlight Switch	20
Automatic High Beams	20
Automatic Headlights	20
WINDSHIELD WIPERS & WASHERS	21
Windshield Wiper Operation	21
CRUISE CONTROL SYSTEMS	22
Adaptive Cruise Control (ACC)	22
PARKING ASSISTANCE	24
ParkSense Rear Park Assist System — If Equipped	24
OFFROAD FEATURES	24
Trac-Lok Rear Axle — If Equipped	24
Axle Lock (Tru-Lok) Front And Rear — If Equipped	25
Axle Lock (Tru-Lok) Rear Only — If Equipped	25
Axle Lock (Tru-Lok) Rear Only For High Speed Operation — If Equipped	26
Electronic Sway Bar Disconnect — If Equipped	27
Off Road+ — If Equipped	27

EXTERIOR

EXTERIOR OVERVIEW	29
EXTERIOR CAMERA VIEWS	30
Back Up Camera	30

Trailcam System — If Equipped	30
HOOD	30
To Open The Hood	30
To Close The Hood	31
TAILGATE	31
Opening	31
REFUELING THE VEHICLE	31

EMERGENCY

JACKING AND TIRE CHANGING	33
Preparations For Jacking	33
Jack Location	33
Spare Tire Location And Removal	33
Jacking Instructions	34
JUMP STARTING	36
Preparations For Jump Starting	36
Jump Starting Procedure	37
FREEING A STUCK VEHICLE	38
TOWING A DISABLED VEHICLE	39
Towing In An Emergency	39

SPECIFICATIONS

ENGINE COMPARTMENT OVERVIEW	42
3.6L Engine	42
FLUID CAPACITIES	43
ENGINE FLUIDS AND LUBRICANTS	43
CHASSIS FLUIDS AND LUBRICANTS	44
SERVICING AND MAINTENANCE	45

Schedule Servicing	45
Oil Change Reset — If Equipped	45
Engine Break-In Recommendations	45
TRAILER TOWING WEIGHTS (MAXIMUM TRAILER WEIGHT RATINGS)	45

OWNER HANDBOOK INTRODUCTION

Thank you for choosing Jeep®. This Owner Handbook has been prepared to help you quickly become acquainted with important features of your vehicle. It contains most things you will need to operate and maintain your vehicle, including emergency information.

This handbook illustrates and describes the operation of certain features and equipment that come either standard or optional on your vehicle. It may include a description of features and equipment that your vehicle is not equipped with. FCA International Operations LLC (FCAIO) reserves the right to make changes in design and specifications and/or make additions to or improvements to its products without imposing any obligation upon itself to install them on products previously manufactured.





FCA International Operations LLC is committed to protecting the environment and invites you to scan this QR code to access the complete Owner's Manual.

NOTE:

For more information, please refer to your Consumer Information Guide, and complete Owner's Manual, available online.

SYMBOLS KEY

WARNING!	These statements apply to operating procedures that could result in a collision, bodily injury and/or death.
CAUTION!	These statements apply to procedures that could result in damage to your vehicle.
NOTE:	A suggestion which will improve installation, operation, and reliability. If not followed, may result in damage.
TIP:	General ideas/solutions/suggestions on easier use of the product or functionality.
 PAGE REFERENCE ARROW	Follow this reference for additional information on a particular feature.
 FOOTNOTE	Supplementary and relevant information pertaining to the topic.

If you do not read the entire Owner's Manual, you may miss important information. Observe all Cautions and Warnings.

IF YOU NEED ASSISTANCE

(*) Customer Service offers information and assistance on products, services, dealerships and 24H Roadside Assistance. It can be contacted from the main European countries by calling the Universal Toll Free Number. In case of problems, please use the Local Toll Free Number or the International Toll Number.

FCAIO's distributors are vitally interested in your satisfaction with their products and services. If a servicing problem or other difficulty should occur, we recommend that you take the following steps:

Discuss the problem at the authorized dealer with the dealer principal or the service manager. Management personnel at the authorized dealer are in the best position to resolve the problem.

When you contact the distributor please provide all of the following information:

- Your name, address and phone number.
- Vehicle Identification Number (this 17-digit number is found on a label, located on the left front corner of the instrument panel, visible through the windshield. It is also available from your vehicle registration or title).
- Selling and servicing authorized dealer.
- Vehicle's delivery date and current odometer distance.

- Service history of your vehicle.
- An accurate description of the problem and the conditions under which it occurs.

ARGENTINA

Customer Care RSA Support 24hs (Chrysler, Jeep®, Dodge & Ram)

FCA Automobiles Argentina S.A.

Carlos Maria Della Paolera 299

Piso 25 Caba

Buenos Aires, Argentina

Local Toll Free Number Tel: 0 800 333 7070
(option: 1)

AUSTRALIA

Stellantis (Australia and New Zealand) Pty. Ltd.

ABN 23 125 956 505

PO Box 23267, Docklands Victoria 3008

Tel: 1300 133 079

BALANCE OF THE CARIBBEAN

Interamericana Trading Corporation

Warrens, St. Michael

Barbados, West Indies

BB22026, PO Box 98

Tel.: 246-417-8000

Fax: 246-425-2888

BOLIVIA

Ovando & Cia S.A.

Av. Cristobal de Mendoza (2do Anillo) y Canal Isuto

Santa Cruz, Bolivia

PO Box 6852

Tel.: (591-3) 336 3100

Fax: (591-3) 334 0229

BRAZIL

FCA FIAT® CHRYSLER AUTOMÓVEIS BRASIL LTDA

Contorno Avenue, 3455 - Paulo Camilo, Betim - MG, 32669-900

Tel: +55 0800 703 7150

CHILE

Comercial Fiat Chrysler SpA

Avenida Américo Vespucio Norte 1561, 8th floor.

Vitacura, Santiago. CHILE

Zip Code 101931-7, 367-V

Tel.: +562 25830990

Fax: +562 6039196

CHINA

Shanghai Stellantis Automobile Company

8th floor, Building A2, Gumei Road

Shanghai

PR. China

Zip Code 200233

Tel: 400-650-0118

COLOMBIA

Automotriz Italoamerica

Of. Cr 45 # 108 - 27 Torre 3, Piso 12

Parallel Building 108

Bogota, D.C. | Colombia

Zip Code 111111

Tel: +57 (601) 519 0055

Fax: 01 8000 919 168

COSTA RICA

AutoStar

La Uruca, frente al Banco Nacional

San José, Costa Rica

PO Box 705-1150

Tel.: (506) 295 - 0000

Fax: (506) 295 - 0052

DOMINICAN REPUBLIC

Reid y Compañía

John F. Kennedy Casi Esq. Lope de Vega

Santo Domingo, Dominican Republic

Tel.: (809) 562-7211

Fax: (809) 565-8774

ECUADOR

Corporacion Maresa, Distrivehic

Avenida De los Granados E11-67

Quito, Ecuador

Tel.: 593 1800 627 372

EL SALVADOR

Grupo Q del Salvador

Ave. Las Amapolas (Autopista Sur)

Bld. Los Próceres y Avenida No. 1, Lomas de San Francisco,

San Salvador, El Salvador

Zip Code 152

Tel.: +503 2248 6400

Fax: +503 278 5731

EUROPE

Jeep® Customer Service

The Jeep® Assistance Service for customers is available 24 hours a day, seven days a week. If you require assistance, see the provided contact information.

To access service from the UK, dial the telephone number then select option "Roadside Assistance"; if accessing the service from abroad, select option "International Services" and select your language.

Universal Toll Free Number*

Tel: 00 800 0 426 5337

Local Toll Free Number

Tel: 0800 1692966

International Toll Number

Tel: +39 02 444 12 045

GUATEMALA

Grupo Q del Guatemala

Km 16 carretera a El Salvador, condado concepción

Ciudad de Guatemala, Guatemala

Zip Code 1004

Tel.: +502 6685 9500

HONDURAS

Grupo Q de Honduras

Blvd. Centro América frente a Plaza Miraflores,

Tegucigalpa, Honduras

Tel.: +504 2290 3700

Fax: +504 2232 6564

INDIA

FCA India Automobiles Private Limited

Registered Office:

Giga space IT part, Delta One, 4th floor

Viman nagar, Pune- 411 014

Maharashtra

India

Tel: +91 20 30184500

Toll free: 1800-266-5337

Roadside Assistance: 1800-102-5337

JAPAN

Jeep® Free Call

Local Toll Free Number

Tel: 0120-712-812

NEW ZEALAND

Jeep® Customer Service

P O Box 12075, Penrose 1642

Auckland, New Zealand

Tel: +64 9 979 8000

PANAMA

Automotora Autostar S.A.

Avenida Domingo Díaz, Vía Tocumen, Frente a la Urbanización El Crisol

Panamá, Panamá

Tel.: +507 233 7222

Fax: +507 233 2843

* The Universal and UK telephone number is free for most calls from landlines and mobile phones. Calls from certain mobile phones and public telephones in some European countries may be charged according to the rates applied by the telephone operator. You are invited to check with the operator before proceeding. Each service must be authorized by the Jeep® Assistance Service. If you are unable to call the number, take the necessary actions and then inform the operator. In the latter case, expenses incurred will be reimbursed after providing appropriate receipts.

PARAGUAY

Garden Autolider S.A.

Av. República de Argentina esq. Facundo Machain

Asuncion, Paraguay

Tel.: +595 21 664 580

Fax: +595 21 664 579

PERU

Divemotor S.A.

Av. Canada 1160, Urb. Sta. Catalina

Lima, Peru

Zip Code Lima 13

Tel.: (51-1) 712 2000

Fax: (51-1) 712 2002

PUERTO RICO AND U.S. VIRGIN ISLANDS

FCA Caribbean LLC

P.O. Box 191857

San Juan 00919-1857

Phone: (877) 426-5337

REUNION

COTRANS AUTOMOBILES

17 Bd du Chaudron, 97490 Sainte Clotilde

Tel: 0262920000

Fax: 0262488443

SOUTH AFRICA

Jeep® Customer Service

Universal Toll Free Number

Tel: 8066727869

International Toll Free Number

Tel: +27102525000

TAIWAN

Chrysler Taiwan Co., LTD.

13th Floor Union Enterprise Plaza

1109 Min Sheng East Road, Section 3

Taipei Taiwan R.O.C.

Tel.: 080081581

Fax: 886225471871

URUGUAY

SEVEL Uruguay S.A.

Convenio 820

Montevideo, Uruguay

Zip Code 11700

Tel: +598 220 02980

Fax: +598 2209-0116

VENEZUELA

FCA VENEZUELA, L.L.C.

PANCHO PEPE CROQUER ZONA INDUSTRIAL
NORTE VALENCIA - VENEZUELA PLANTA
CHRYSLER VALENCIA

RIF J-30357530-7 CÓDIGO POSTAL 2001

+58 424 44980678

+58 414 4222516

INTERIOR OVERVIEW



1 — Uconnect Radio Screen Display ➞ page 11

2 — Instrument Cluster Display ➞ page 15

3 — Windshield Wipers and Washers ➞ page 21

4 — Climate Controls ➞ page 17

5 — Instrument Cluster Controls ➞ page 16

6 — USB/AUX Media Hub ➞ page 14

7 — Stop/Start Off Switch ➞ page 10

8 — Keyless Push Button Ignition ➞ page 10

9 — Uconnect Voice Command Buttons ➞ page 12

10 — Cruise Control Buttons ➞ page 22

11 — Headlight Switch ➞ page 20

STARTING AND OPERATING

KEYLESS ENTER 'N GO™ — PASSIVE ENTRY

Keyless Enter 'n Go™ — Passive Entry allows you to lock and unlock the vehicle's door(s) and tailgate without having to push the key fob lock or unlock buttons.

To Unlock/Lock The Vehicle's Doors And Tailgate

With a valid Passive Entry key fob with you, grab the handle to unlock the vehicle. Grabbing the driver's door handle will unlock the driver door automatically. Grabbing the passenger door handle will unlock all doors and the tailgate automatically.

With a valid Passive Entry key fob on you, push the Passive Entry lock button on the door handle to lock the vehicle.

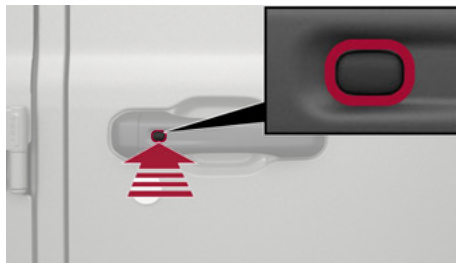

Push The Door Handle Button To Lock

NOTE:

- DO NOT grab the door handle when pushing the lock button. This could unlock the door(s).
- Be sure to keep the vehicle key fob with you.

STOP/START SYSTEM

The Stop/Start function is designed to save fuel and reduce emissions. The system will stop the engine automatically during a vehicle stop if the required conditions are met. Releasing the brake pedal, pressing the accelerator pedal will automatically restart the engine.

NOTE:

It is recommended that the Stop/Start system be disabled during off-road use.

Your vehicle may be equipped with a secondary battery used to power the Stop/Start system and the 12 Volt vehicle electrical system.

Stop/Start System Information

The Stop/Start System status can be viewed in the Electronic Vehicle Information Center (EVIC) Stop/Start page.

How To Turn Off The Stop/Start System

Did you know you can manually turn off your Stop/Start system?

Just push the Stop/Start OFF switch to turn off this feature. The light on the switch will illuminate and the "STOP/START OFF" message will appear in the instrument cluster display.



Stop/Start OFF Switch

NOTE:

The Stop/Start system will reset itself back to the on position every time the ignition is turned off and back on.

MULTIMEDIA & PHONE CONNECTIVITY

Uconnect SYSTEM

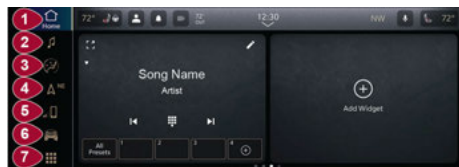

Uconnect 5/5 NAV Display

- 1 — Home Button
- 2 — Radio/Media Button
- 3 — Comfort Button
- 4 — Navigation Button (If Equipped)
- 5 — Phone Button
- 6 — Vehicle Button
- 7 — Apps Button

NOTE:

Uconnect screen images may not reflect the exact software in your vehicle.

Uconnect SETTINGS



Uconnect 5/5 NAV With 12.3-inch Display Uconnect Settings

- 1 — Uconnect Buttons On The Touchscreen
- 2 — Uconnect Buttons On The Faceplate

To customize vehicle settings, press the Vehicle button, then press the Settings button toward the top of your touchscreen to get started with customizing your settings.

NOTE:

Depending on the vehicle's options, feature settings may vary.

- **Display** — Customize features such as your display brightness or set navigation instructions to appear on your instrument cluster display.

- **Safety/Driving Assistance** — Customize settings such as the warning signal and steering wheel strength.
- **Phone/Bluetooth®** — Customize settings related to your paired device.
- **Camera** — Customize the vehicle's camera settings.
- **Seats & Comfort** — Customize your comfort levels with heated seats or heated steering wheel.
- **Key Off Options** — Customize what your vehicle does when it shuts down.
- **Audio** — Customize audio settings.

PAIR/DELETE A DEVICE

1. Make sure Bluetooth® is enabled on your mobile phone.
2. With the vehicle in the ACC or ON/RUN position, press the Phone button on the vehicle's touchscreen menu bar.
3. Press "Device Manager".
4. Select "Add Device".
5. Follow the prompts on your phone and on the touchscreen.

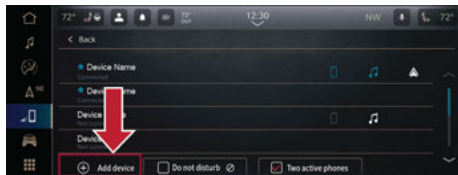

Uconnect 5/5 NAV Pairing A Phone

Follow these steps to remove your smartphone:

1. Press the Device Manager button on the touchscreen.
2. Press the Settings gear icon next to the phone or device you wish to remove.
3. Press "Delete Device". The device should be removed.

APPLE CARPLAY®

1. Ensure your iPhone® is unlocked for the very first connection, then ensure Siri is enabled in "Settings".
2. Connect your iPhone® to one of the media USB ports in your vehicle, or pair your iPhone® with the system. You have no need to plug your device in if it is paired with the system.
3. Once the device is connected and recognized, the Phone icon on the menu bar changes to the Apple CarPlay® icon.

NOTE:

To use Apple CarPlay®, make sure cellular data is turned on and you are in an area with cellular coverage. Your data and cellular coverage is shown on the left side of the touchscreen within Apple CarPlay®. Data plan rates may apply.

ANDROID AUTO™

1. Connect your phone to one of the media USB ports in your vehicle, or pair your phone with the system. You have no need to plug your device in if it is paired with the system.
2. Once the device is connected and recognized, the Phone icon on the menu bar changes to the Android Auto™ icon.

NOTE:

To use Android Auto™, make sure you are in an area with cellular coverage. Android Auto™ may use cellular data, and your cellular coverage is shown in the upper right corner of the touchscreen. Data plan rates may apply.

UCONNECT VOICE RECOGNITION

Introduction

Your vehicle is capable of voice commands, this feature is called Voice Recognition (VR).

Start using Uconnect VR with these helpful quick tips. They provide the key voice commands and

tips you need to know to control your vehicle's VR system.

Basic Voice Commands

The following basic voice commands can be given at any point while using your Uconnect system.

Push the VR button or, for the Uconnect 5/5 NAV, say the vehicle's "Wake Up" word, "Hey, Uconnect". After the beep, say:

- "Cancel" to stop a current voice session.
- "Help" to hear a list of suggested Voice Commands.
- "Repeat" to listen to the system prompts again.

Notice the visual cues that inform you of your VR system's status on your Uconnect system.

NOTE:

If your vehicle is not equipped with Voice Recognition, you may still have voice recognition buttons. These buttons will work with Android Auto™ and Apple CarPlay® by initiating a Siri or Google Assistant voice recognition session. Depending on your device, you may need to press and hold the VR button for one second to begin a voice recognition session.

OFF-ROAD PAGES

Off-Road Pages is an application that provides vehicle status information while operation in off-road conditions. It supplies information relating to the status of the drivetrain, transfer case, coolant/oil gauges, pitch and roll of the vehicle and access to the trailcam system.



Uconnect 5/5 NAV Off-Road Pages

To access the Off-Road Pages:

1. Press the Vehicle button on the touchscreen and select "Dashboard".
2. Press "Off-Road Pages".
3. Press the desired button on the touchscreen to access that specific option within the Off-Road Pages.

CHARGING & OUTLETS

ELECTRICAL POWER OUTLETS

There is a 12 Volt (13 A) auxiliary power outlet that can provide power for accessories designed for use with the standard power outlet adapters.

The front power outlet is located in the center of the instrument panel below the climate controls, and is powered from the ignition switch. Power is available when the ignition switch is in the ACC or ON/RUN position.

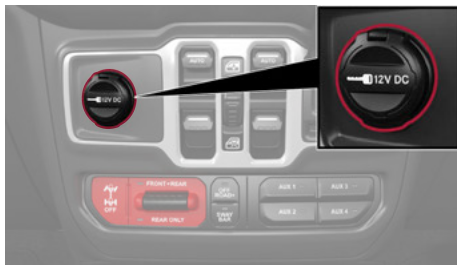

Instrument Panel Power Outlet

NOTE:

- Do not connect any of your devices that have a power rating higher than 160 W to the outlet. Do not use power adapters that do not fit the outlet as this may damage it.

- Power outlets labeled with a key symbol are powered when the ignition is in the ON/RUN position.

WARNING!

To avoid serious injury or death:

- Only devices designed for use in this type of outlet should be inserted into any 12 Volt outlet.
- Do not touch with wet hands.
- Close the lid when not in use and while driving the vehicle.
- If this outlet is mishandled, it may cause an electric shock and failure.

CAUTION!

- Power outlets are designed for accessory plugs only. Do not insert any other object in the power outlets as this will damage the outlet and blow the fuse. Improper use of the power outlet can cause damage not covered by your New Vehicle Limited Warranty.
- Many accessories that can be plugged in draw power from the vehicle's battery, even when not in use (i.e., cellular phones, etc.). Eventually, if plugged in long enough, the

(Continued)

CAUTION!

vehicle's battery will discharge sufficiently to degrade battery life and/or prevent the engine from starting.

- Accessories that draw higher power (i.e., coolers, vacuum cleaners, lights, etc.), will discharge the battery even more quickly. Only use these intermittently and with greater caution.
- After the use of high power draw accessories, or long periods of the vehicle not being started (with accessories still plugged in), the vehicle must be driven a sufficient length of time to allow the generator to recharge the vehicle's battery.

POWER INVERTERS — IF EQUIPPED

There is a 230 V (400 W) maximum inverter outlet located on the back of the center console to convert Direct Current (DC) to Alternating Current (AC).



Power Inverter

NOTE:

400 W is the maximum for the inverter, not each outlet. If two outlets are in use, 400 W is shared among the devices plugged in.

WARNING!

To avoid serious injury or death:

- Do not insert any objects into the receptacles.
- Do not touch with wet hands.
- Close the lid when not in use.
- If this outlet is mishandled, it may cause an electric shock and failure.

USB/AUX CONTROL

Your vehicle may be equipped with two USB ports and one AUX port located on the instrument panel below the climate controls.

You may also have USBs ports in the following locations:

- Inside the center console.
- On the back of the center console.



Front USB/AUX Ports

- 1 — AUX Port
- 2 — USB Type C
- 3 — USB Type A

Plugging in a mobile device to a USB port below the Uconnect screen may activate the Android Auto™ or Apple CarPlay® features.

INSTRUMENT CLUSTER

GETTING TO KNOW YOUR INSTRUMENT CLUSTER



NOTE:

Depending on your vehicle trim, your instrument cluster display may vary.

1. Tachometer

- Indicates the engine speed in revolutions per minute (RPM x 100).

2. Temperature Gauge

- The temperature gauge shows engine coolant temperature. Any reading within the normal range indicates that the engine is operating satisfactorily.

3. Instrument Cluster Display

- When the appropriate conditions exist, this display shows the instrument cluster display messages.
- The display always shows one of the main menu items after ignition is placed on.

4. Fuel Gauge

- The gauge shows the level of fuel in the fuel tank when the Keyless Push Button Ignition is in the ON/RUN position.

-  The fuel pump symbol points to the side of the vehicle where the fuel door is located.

5. Speedometer

- Indicates vehicle speed.

INSTRUMENT CLUSTER DISPLAY LOCATION AND CONTROLS

The instrument cluster display is located in the center of the instrument cluster.

The system allows the driver to select information by pushing the instrument cluster display control buttons located on the left side of the steering wheel.



Instrument Cluster Display Control Buttons

● Left Arrow Button

Push and release the **left** ◀ arrow button to access the information screens or submenu screens of a main menu item.

● Up Arrow Button

Push and release the **up** ▲ arrow button to scroll upward through the Main Menu items.

● Right Arrow Button

Push and release the **right** ▶ arrow button to access the information screens or submenu screens of a main menu item.

● Down Arrow Button

Push and release the **down** ▼ arrow button to scroll downward through the Main Menu items.

● OK Button

Push the **OK** button to access/select the information screens or submenu screens of a Main Menu item. Push and hold the **OK** arrow button for two seconds to reset displayed/selected features that can be reset.

WARNING LIGHTS AND MESSAGES

Warning lights, indicators, and messages appear to signify various vehicle conditions. See the Quick Start Guide or Owner's Manual for examples and detailed descriptions. Some telltales are optional according to vehicle equipment.

INTERIOR COMFORT SETTINGS

CLIMATE CONTROLS

The Climate Control system allows you to regulate the temperature, air flow, and direction of air circulating throughout the vehicle.



Uconnect 5/5 NAV Automatic Climate Controls

AUTOMATIC CLIMATE CONTROL DESCRIPTIONS AND FUNCTIONS

MAX A/C Button



Press the button on the touchscreen to set the system to maximum Air Conditioning (A/C).

A/C Button



Push the button to engage the Air Conditioning (A/C) system.

Recirculation Button



Push the button to change the system between Recirculation mode and outside air mode.

Auto Button



Push the button after setting your desired temperature and the system will maintain the set temperature.

SYNC Button



Press the SYNC button on the touchscreen to synchronize the driver and front passenger temperature settings.

Driver And Passenger Temperature Controls



Push the driver or passenger's side toggle switch upward or downward, or slide the temperature bar to adjust the driver and passenger temperature settings.

Front Defrost Button

Push the Front Defrost Button to change the current airflow setting to Defrost mode.

Rear Defrost Button

Push the Rear Defrost Button to turn on the rear window defroster and heated mirrors.

CAUTION!

Failure to follow these cautions can cause damage to the heating elements:

- Use care when washing the inside of the rear window. Do not use abrasive window cleaners on the interior surface of the window. Use a soft cloth and a mild washing solution, wiping parallel to the heating

(Continued)

CAUTION!

elements. Labels can be peeled off after soaking with warm water.

- Do not use scrapers, sharp instruments, or abrasive window cleaners on the interior surface of the window.
- Keep all objects a safe distance from the window.

Blower Control

Use the blower control dial or the blower bar on the touchscreen to increase or decrease the amount of air forced through the climate control system.

Mode Control

Select Mode by pressing one of the Mode buttons on the touchscreen, or the mode control knob, to change the airflow distribution mode.

Climate Control OFF Button

Press the Off Button to turn the climate control system off.

AUTOMATIC TEMPERATURE CONTROL (ATC)

Automatic Operation

1. Push the AUTO button on the faceplate or the AUTO button on the touchscreen.
2. Select the desired temperature using the toggle switches or the touchscreen. The system then achieves and automatically maintains that comfort level.

NOTE:

There will be no need for you to move the temperature settings for cold or hot vehicles. The system automatically adjusts the temperature, mode, and blower speed to provide comfort as quickly as possible.

Manual Operation Override

Your Climate Control system includes manual override features. The AUTO symbol in the front ATC display will turn off when the system is in the manual mode.

CLIMATE VOICE RECOGNITION

You can adjust your vehicle's temperature hands-free while you're driving.

Push the VR button on the steering wheel. After the beep, say one of the following commands:

- "Set driver temperature to 20 degrees"
- "Set passenger temperature to 20 degrees"

FRONT HEATED SEATS — IF EQUIPPED



The heated seat control buttons are located on the center instrument panel below the touchscreen and also in the Climate Control touchscreen menu. Press the heated seat button to cycle through HI, MED, LO, and off settings.

WARNING!

- Persons who are unable to feel pain to the skin because of advanced age, chronic illness, diabetes, spinal cord injury, medication, alcohol use, exhaustion or other physical condition must exercise care when using the seat heater. It may cause burns even at low temperatures, especially if used for long periods of time.
- Do not place anything on the seat or seatback that insulates against heat, such as a blanket or cushion. This may cause the seat heater to overheat. Sitting in a seat that has been overheated could cause serious burns due to the increased surface temperature of the seat.

POWER FRONT SEATS ADJUSTMENT — IF EQUIPPED

The power seat switch and power seat recline switch are located on the outboard side of the seat near the floor. Use the power seat switch to adjust seat height, angle, or forward/rearward position. Use the power seat recline switch to adjust the angle of the seatback.

Push the power lumbar switch forward to increase the lumbar support. Push the switch rearward to decrease the lumbar support. Pushing upward or downward on the switch will raise and lower the position of the support.



Power Seat Switches

- 1 — Power Recline Switch
- 2 — Power Seat Switch
- 3 — Power Lumbar Switch

WARNING!

Do not ride with the seatback reclined so that the shoulder belt is no longer resting against your chest. In a collision you could slide under the seat belt, which could result in serious injury or death.

HEAD RESTRAINTS

Your vehicle is equipped with front driver and passenger head restraints that can be adjusted two different ways.

Head restraints are designed to reduce the risk of injury by restricting head movement in the event of a rear impact. Head restraints should be adjusted so that the top of the head restraint is located above the top of your ear.



Head Restraint Buttons

- 1 — Removal Button
- 2 — Adjustment Button

- To raise the head restraint, pull upward on the head restraint.
- To lower the head restraint, push the adjustment button, located at the base of the head restraint, while pushing downward on the head restraint.

Rear Head Restraints

The rear seat is equipped with non-adjustable, but foldable, outboard head restraints.

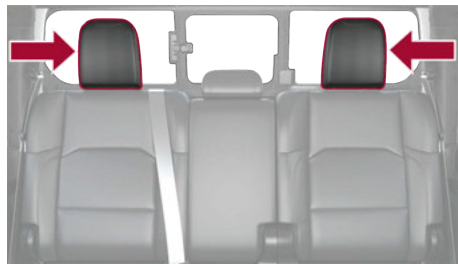

Rear Foldable Outboard Head Restraints

To return the head restraint to its upward position, lift up on the head restraint until it locks into place.

To raise the center head restraint, lift up on the head restraint. To lower the center head restraint, push the adjustment button, located at the base of the head restraint, and push down on the head restraint.

To remove the center head restraint, raise it as far as it can go. Then, push the adjustment button and the release button at the base of each post while pulling the head restraint up.

NOTE:

Lower the center head restraint to avoid contact with the center console when folding the seat down.

WARNING!

- Do not drive the vehicle without the rear seat head restraints installed while passengers are occupying the rear seat. In a collision, people riding in this area without the head restraints installed are more likely to be seriously injured or killed.
- A loose head restraint thrown forward in a collision or hard stop could cause serious injury or death to occupants of the vehicle. Always securely stow removed head restraints in a location outside the occupant compartment.

(Continued)

WARNING!

- ALL the head restraints MUST be reinstalled in the vehicle to properly protect the occupants. Follow the preceding reinstallation instructions prior to operating the vehicle or occupying a seat.

LIGHTING OPERATION

HEADLIGHT SWITCH

The headlight switch is located on the right side of the instrument panel and is used to control your lighting.



Headlight Switch

- 1 – Dimmer Control
- 2 – Ambient Light Dimmer Control (If Equipped)
- 3 – Rotate Headlight Switch
- 4 – Push Front/Rear Fog Light
- 5 – Push Bed Light

Rotate the headlight switch clockwise to the first detent for parking lights and instrument panel light operation. Rotate the headlight switch to the second detent for headlights, parking lights, and instrument panel light operation.

Rotate the headlight control knob to select one of the available positions: O (off), parking lights, headlights on, and AUTO headlights.

AUTOMATIC HIGH BEAMS

Did you know your vehicle can automatically switch from high beams to low beams until an approaching vehicle is out of view?

The Automatic High Beam Headlight Control can be turned on or off by selecting “ON” under “Auto High Beam” within your Uconnect Settings, as well as turning the headlight switch to the AUTO position and placing the multifunction lever in the high beam position.

AUTOMATIC HEADLIGHTS

With the engine running, make sure your headlight control knob is in the AUTO position; your vehicle will detect how bright it is outside and turn the headlights on/off as necessary.

WINDSHIELD WIPERS & WASHERS

The windshield wiper/washer controls are located on the windshield wiper/washer lever on the right side of the steering column. The front wipers are operated by rotating a switch, located on the end of the lever.

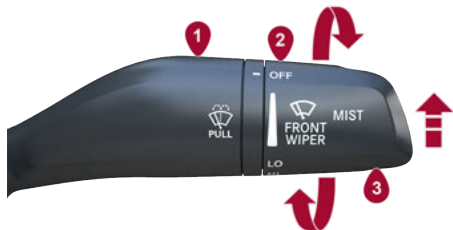

Windshield Wiper/Washer Lever

- 1 — Pull For Windshield Washer
- 2 — Rotate For Wiper Operation
- 3 — Push Up For Mist

WINDSHIELD WIPER OPERATION

Front Wipers

Rotate the end of the lever upward to the first detent past the intermittent settings for low-speed wiper operation.

Rotate the end of the lever upward to the second detent past the intermittent settings for high-speed wiper operation.

Windshield Washers

To use the washer, pull the windshield wiper lever toward the steering wheel and hold.

Mist

Push the lever upward to the MIST position and release for a single wiping cycle.

NOTE:

The mist feature does not activate the washer pump; therefore, no washer fluid will be sprayed on the windshield. The washer function must be used in order to spray the windshield with washer fluid.

WARNING!

Sudden loss of visibility through the windshield could lead to a collision. You might not see other vehicles or other obstacles. To avoid sudden icing of the windshield during

(Continued)

WARNING!

freezing weather, warm the windshield with the defroster before and during windshield washer use.

CAUTION!

- Always remove any buildup of snow that prevents the windshield wiper blades from returning to the parked position. If the windshield wiper switch is turned off, and the blades cannot return to the parked position, damage to the wiper motor may occur.
- In cold weather, always turn off the wiper switch and allow the wipers to return to the park position before turning off the engine. If the wiper switch is left on and the wipers freeze to the windshield, damage to the wiper motor may occur when the vehicle is restarted.

CRUISE CONTROL SYSTEMS

Your vehicle may be equipped with the Cruise Control system, or the Adaptive Cruise Control (ACC) system:

- Cruise Control will keep your vehicle at a constant preset speed.
- Adaptive Cruise Control (ACC) will adjust the vehicle speed up to the preset speed to maintain a distance with the vehicle ahead.

NOTE:

In vehicles equipped with ACC, if ACC is not enabled, Fixed Speed Cruise Control will not detect vehicles directly ahead of you. Only one Cruise Control feature can operate at a time.

ADAPTIVE CRUISE CONTROL (ACC)

WARNING!

- Adaptive Cruise Control (ACC) is a convenience system. It is not a substitute for active driver involvement. It is always the driver's responsibility to be attentive of road, traffic, and weather conditions, vehicle speed, distance to the vehicle ahead and, most importantly, brake operation to

(Continued)

WARNING!

ensure safe operation of the vehicle under all road conditions. Your complete attention is always required while driving to maintain safe control of your vehicle. Failure to follow these warnings can result in a collision and death or serious personal injury.

- The ACC system:
 - Does not react to pedestrians, oncoming vehicles, and stationary objects (e.g., a stopped vehicle in a traffic jam or a disabled vehicle).
 - Cannot take street, traffic, and weather conditions into account, and may be limited upon adverse sight distance conditions.
 - Does not always fully recognize complex driving conditions, which can result in wrong or missing distance warnings.
 - Will bring the vehicle to a complete stop while following a vehicle ahead and hold the vehicle for two seconds in the stop position. If the vehicle ahead does not start moving within two seconds the ACC system will display a message that the system will release the brakes and that the brakes must be applied manually. An

(Continued)

WARNING!

audible chime will sound when the brakes are released.

- You should not utilize the ACC system:
 - When driving in fog, heavy rain, heavy snow, sleet, heavy traffic, and complex driving situations (i.e., in highway construction zones).
 - When entering a turn lane or highway off-ramp; when driving on roads that are winding, icy, snow-covered, slippery, or have steep uphill or downhill slopes.
 - When towing a trailer up or down steep slopes.
 - When circumstances do not allow safe driving at a constant speed.

The buttons on the right side of the steering wheel operate the Cruise Control and ACC systems.



Adaptive Cruise Control Buttons

- 1 — Distance Setting Increase
- 2 — SET (+)/Accel
- 3 — CANCEL/Cancel
- 4 — RES/Resume
- 5 — ACC On/Off
- 6 — Fixed Speed Cruise Control On/Off
- 7 — Distance Setting Decrease
- 8 — SET (-)/Decel

● To Activate/Deactivate

- Push and release the Adaptive Cruise Control (ACC) on/off button.

WARNING!

Leaving the Adaptive Cruise Control (ACC) system on when not in use is

(Continued)

WARNING!

dangerous. You could accidentally set the system or cause it to go faster than you want. You could lose control and have a collision. Always leave the system off when you are not using it.

● To Set A Desired ACC Speed

- When the vehicle reaches the speed desired, push the SET (+) button or the SET (-) button and release. The instrument cluster display will show the set speed.

WARNING!

In Fixed Speed Cruise Control mode, the system will not react to vehicles ahead. In addition, the proximity warning does not activate and no alarm will sound even if you are too close to the vehicle ahead since neither the presence of the vehicle ahead nor the vehicle-to-vehicle distance is detected. Be sure to maintain a safe distance between your vehicle and the vehicle ahead. Always be aware which mode is selected.

● To Deactivate

- To turn the system off, push and release the Adaptive Cruise Control (ACC) on/off

button again, or by placing your vehicle's ignition in the OFF position.

● To Resume Speed

- If ACC was canceled, and there is a set speed in memory, push the RES (resume) button.

WARNING!

The Resume function should only be used if traffic and road conditions permit. Resuming a set speed that is too high or too low for prevailing traffic and road conditions could cause the vehicle to accelerate or decelerate too sharply for safe operation. Failure to follow these warnings can result in a collision and death or serious personal injury.

● To Vary The Speed Setting

- After setting a speed, you can increase the set speed by pushing the SET (+) button, or decrease speed by pushing the SET (-) button.

● Setting The Following Distance In ACC

- To increase the distance setting, push the Distance Setting Increase button and release. Each time the button is pushed, the distance setting increases by one bar (longer).

- To decrease the distance setting, push the Distance Setting Decrease button and release. Each time the button is pushed, the distance setting decreases by one bar (shorter).

PARKING ASSISTANCE

PARKSENSE REAR PARK ASSIST SYSTEM — IF EQUIPPED

Enable and disable the ParkSense system using the ParkSense switch, located in front of the center console, below the climate controls.



ParkSense Switch

WARNING!

- Drivers must be careful when backing up even when using ParkSense. Always check carefully behind your vehicle, look behind you, and be sure to check for pedestrians, animals, other vehicles, obstructions, and blind spots before backing up. You are responsible for safety and must continue to pay attention to your surroundings. Failure to do so can result in serious injury or death.
- Before using ParkSense, it is strongly recommended that the ball mount and hitch ball assembly be disconnected from the vehicle when the vehicle is not used for towing. Failure to do so can result in injury or damage to vehicles or obstacles because the hitch ball will be much closer to the obstacle than the rear fascia/bumper when the vehicle sounds the continuous tone. Also, the sensors could detect the ball mount and hitch ball assembly, depending on its size and shape, giving a false indication that an obstacle is behind the vehicle.

CAUTION!

- ParkSense is only a parking aid and it is unable to recognize every obstacle,

(Continued)

CAUTION!

- including small obstacles. Parking curbs might be temporarily detected or not detected at all. Obstacles located above or below the sensors will not be detected when they are in close proximity.
- The vehicle must be driven slowly when using ParkSense in order to be able to stop in time when an obstacle is detected. It is recommended that the driver looks over his/her shoulder when using ParkSense.

OFFROAD FEATURES

TRAC-LOK REAR AXLE — IF EQUIPPED

The Trac-Lok rear axle provides a constant driving force to both rear wheels and reduces wheel spin caused by the loss of traction at one driving wheel. If traction differs between the two rear wheels, the differential automatically proportions the usable torque by providing more torque to the wheel that has traction.

Trac-Lok is especially helpful during slippery driving conditions. With both rear wheels on a slippery surface, a slight application of the accelerator will supply maximum traction.

WARNING!

On vehicles equipped with a limited-slip differential, never run the engine with one rear wheel off the ground. The vehicle may drive through the rear wheel remaining on the ground and cause you to lose control of your vehicle.

AXLE LOCK (TRU-LOK) FRONT AND REAR — IF EQUIPPED

The AXLE LOCK switch is located on the instrument panel (to the right of the steering column).

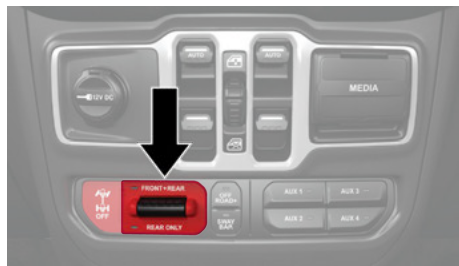

Axle Lock Switch Panel

This feature will only activate when the following conditions are met:

- Ignition in RUN position, vehicle in 4L (Four-Wheel Drive Low Range).
- Vehicle speed should be 10 mph (16 km/h) or less.
- Both right and left wheels on axle are at the same speed.

To activate the system, push the AXLE LOCK switch down to lock the rear axle only (the “REAR ONLY” will illuminate), push the switch up to lock the front axle and rear axle (the “FRONT + REAR” will illuminate). When the rear axle is locked, pushing the bottom of switch again will lock or unlock the front axle.

NOTE:

The indicator lights will flash until the axles are fully locked or unlocked.

To unlock the axles, push the AXLE LOCK OFF button.

Axle Lock will disengage if the vehicle is taken out of 4L, or the ignition switch is turned to the OFF position.

AXLE LOCK (TRU-LOK) REAR ONLY — IF EQUIPPED

The rear axle may be locked in 4H (Four-Wheel Drive High Range) if the proper conditions are met.

The AXLE LOCK switch is located on the instrument panel (to the right of the steering column).

WARNING!

This mode is intended for off-highway or off-road use only and should not be used on any public roadways.

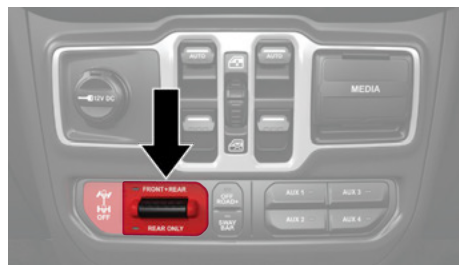

Axle Lock Switch Panel

This feature will only activate when the following conditions are met:

- Ignition in RUN position, vehicle in 4L (Four-Wheel Drive Low Range).
- Vehicle speed should be 10 mph (16 km/h) or less.
- Both right and left wheels on the axle are at the same speed.

To activate the rear system, push the AXLE LOCK switch down to lock the rear axle only (the “REAR ONLY” will illuminate).

NOTE:

The indicator lights will flash until the rear axle is fully locked or unlocked.

To unlock the axle, push the AXLE LOCK OFF button.

Axle lock will disengage if the vehicle is taken out of 4L.

The axle lock disengages at speeds above 30 mph (48 km/h), and will automatically re-lock once vehicle speed is less than 10 mph (16 km/h).

AXLE LOCK (TRU-LOK) REAR ONLY FOR HIGH SPEED OPERATION — IF EQUIPPED

The rear axle may be locked in 4H for high speed vehicle operation if the proper conditions are met and if equipped with either Front and Rear or Rear Only axle lock.

WARNING!

This mode is intended for off-highway or off-road use only and should not be used on any public roadways.

The AXLE LOCK switch is located on the instrument panel (to the right of the steering column).

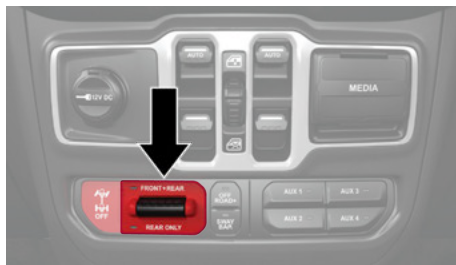

Axle Lock Switch Panel

This feature will only activate when the following conditions are met:

- Ignition in RUN position, vehicle in 4H (Four-Wheel Drive High Range).
- The vehicle must first be in Off Road+ active Off Road+ — If Equipped.
- Vehicle must then be placed in ESC “Full Off” mode ESC Operating Modes (please fully read all ESC Full Operation details).
- Vehicle must not be actively in a high wheel slip or tight cornering condition.

To activate the rear system, push the AXLE LOCK switch down to lock the rear axle only (the “REAR ONLY” will illuminate).

To unlock the axle, push the AXLE LOCK OFF button.

Axle lock will disengage if the vehicle is taken out of 4H (Four-Wheel Drive High Range), Off Road+ is turned off by the driver, ESC “Full Off” is exited, or the ignition switch is turned to the OFF position.

NOTE:

The indicator lights will flash until the rear axle is fully locked or unlocked.

The rear axle lock system may temporarily disengage the rear locker under some conditions.

If this occurs, the rear axle will automatically re-lock as soon as the system allows.

If an axle lock request cannot be completed by the system within 5 seconds due to vehicle operating conditions not being correct, the request will be canceled and the driver may need to re-request the locker to be activated.

ELECTRONIC SWAY BAR DISCONNECT — IF EQUIPPED

Your vehicle may be equipped with an electronic disconnecting stabilizer/sway bar.



SWAY BAR Switch

Push the SWAY BAR switch to activate the system. Push the switch again to deactivate the system. The Sway Bar Indicator Light (located in the instrument cluster) will illuminate when the bar is disconnected. The Sway Bar Indicator

Light will flash during activation transition, or when activation conditions are not met. The stabilizer/sway bar should remain in on-road mode during normal driving conditions.

WARNING!

Ensure the stabilizer/sway bar is reconnected before driving on hard surfaced roads or at speeds above 18 mph (29 km/h); a disconnected stabilizer/sway bar may contribute to the loss of vehicle control, which could result in serious injury. Under certain circumstances, the front stabilizer/sway bar enhances vehicle stability and assists with vehicle control. The system monitors vehicle speed and will attempt to reconnect the stabilizer/sway bar at speeds over 18 mph (29 km/h). This is indicated by a flashing or solid Sway Bar Indicator Light. Once vehicle speed is reduced below 14 mph (22 km/h), the system will once again attempt to return to off-road mode.

NOTE:

The stabilizer/sway bar may be torque locked due to left and right suspension height differences. This condition is due to driving surface differences or vehicle loading. In order for the stabilizer/sway bar to disconnect/reconnect, the right and left halves of the bar must be aligned. This alignment may require

that the vehicle be driven onto level ground or rocked from side to side.

WARNING!

If the stabilizer/sway bar will not return to on-road mode, the Sway Bar Indicator Light will flash in the instrument cluster and vehicle stability may be reduced. Do not attempt to drive the vehicle over 18 mph (29 km/h). Driving faster than 18 mph (29 km/h) with a disconnected stabilizer/sway bar may contribute to the loss of vehicle control, which could result in serious injury.

OFF ROAD+ — IF EQUIPPED

To activate Off Road+, push the OFF ROAD+ switch in the switch bank when in 4WD.

When Off Road+ is active, the following features will activate:

- The Off Road+ telltale will illuminate in the instrument cluster display
- A mode-specific message will display the instrument cluster display
- Off-Road Pages will launch on the radio head-unit if selected in radio settings
- The TrailCam System will launch if selected in radio settings

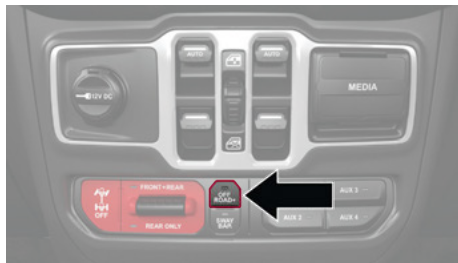

OFF ROAD+ Switch

Once in Off Road+, the vehicle will begin to behave in different ways depending on the 4WD mode in use.

EXTERIOR OVERVIEW



1 — Exterior Camera Locations ➞ page 30

2 — Tailgate Release Handle ➞ page 31

3 — Emergency Tow Hook ➞ page 39

EXTERIOR CAMERA VIEWS

BACK UP CAMERA

The ParkView Rear Back Up Camera allows you to see an on-screen image of the rear surroundings of your vehicle whenever the gear selector is put into REVERSE.

Manual Activation Of The Rear View Camera:

1. Press the Vehicle button on the Uconnect touchscreen and then select Camera.
2. Press the Back Up Camera button to turn the Rear View Camera system on.

WARNING!

Drivers must be careful when backing up even when using the ParkView Rear Back Up Camera. Always check carefully behind your vehicle, and be sure to check for pedestrians, animals, other vehicles, obstructions, or blind spots before backing up. You are responsible for the safety of your surroundings and must continue to pay attention while backing up. Failure to do so can result in serious injury or death.

CAUTION!

- To avoid vehicle damage, ParkView should only be used as a parking aid. The ParkView camera is unable to view every obstacle or object in your drive path.
- To avoid vehicle damage, the vehicle must be driven slowly when using ParkView to be able to stop in time when an obstacle is seen. It is recommended that the driver look frequently over his/her shoulder when using ParkView.

TRAILCAM SYSTEM — IF EQUIPPED

The TrailCam system allows you to see an on-screen image of the front view of your vehicle.

Manual Activation Locations For The TrailCam:

- Press the FWD Camera button on the Camera screen.
- Press the Forward Facing Camera button on the apps menu.
- Press the TrailCam button on the Off-Road Pages.

HOOD

To Open The Hood

To open the hood:

1. Release both of the outside hood latches. Raise the hood slightly, and place a hand palm-side down in the center of the hood opening. Locate the safety latch in the middle, and push the latch to the right to open.

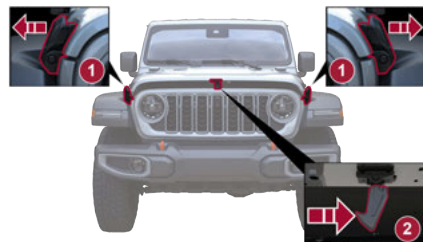

Hood Opening

- 1 — Hood Latch Locations
- 2 — Safety Latch Location

2. Remove the support rod from the hood, and insert it into the radiator crossmember.

NOTE:

- Vehicle must be at a stop and the gear selector must be in PARK.
- Before lifting the hood, check that the wiper arms are not in motion and not in the lifted position.
- While lifting the hood, use both hands.
- Pressing down on the hood may need to occur before pushing the safety latch.

To Close The Hood

To close the hood, remove the support rod from the radiator crossmember, and install into the clip on the hood. Lower the hood slowly. Secure both of the hood latches.

WARNING!

Be sure the hood is fully latched before driving your vehicle. If the hood is not fully latched, it could open when the vehicle is in motion and block your vision. Failure to follow this warning could result in serious injury or death.

CAUTION!

To prevent possible damage, do not slam the hood to close it. Use a firm downward push at the front center of the hood to ensure that both latches engage.

TAILGATE**OPENING**

To open the tailgate, pull the release handle located on the center of the tailgate and guide it to the lowered position.

The tailgate is dampened to provide a slower, more controlled lowering.



Tailgate Release Handle

REFUELING THE VEHICLE

The fuel filler cap is located on the left side of the vehicle. To access the fuel filler cap, push on the fuel filler door to unlatch it. To close the fuel filler door, push on it a second time. If the fuel filler cap is lost or damaged, be sure the replacement cap is the correct one for this vehicle.

1. Open the fuel filler door.
2. Remove the fuel cap by rotating it counterclockwise.



Fuel Filler Cap

3. Fully insert the gasoline nozzle into the filler pipe. Fill the vehicle with fuel.
4. When the fuel nozzle “clicks” or shuts off, the fuel tank is full. Wait five seconds before removing the fuel nozzle to allow excess fuel to drain from nozzle.
5. Remove gasoline nozzle, reinstall fuel cap and close the fuel filler door.

WARNING!

- Never have any smoking materials lit in or near the vehicle when the fuel door is open or the tank is being filled.
- A fire may result if fuel is pumped into a portable container that is inside of a vehicle. You could be burned. Always place fuel containers on the ground while filling.

CAUTION!

- Damage to the fuel system or emission control system could result from using an improper fuel filler cap. A poorly fitting cap could let impurities into the fuel system. Also, a poorly fitting aftermarket cap can cause the Malfunction Indicator Light (MIL) to illuminate, due to fuel vapors escaping from the system.
- To avoid fuel spillage and overfilling, do not “top off” the fuel tank after filling.

NOTE:

- When the fuel nozzle “clicks” or shuts off, the fuel tank is full.
- Tighten the fuel filler cap about a quarter turn until you hear one click. This is an indication that the cap is properly tightened.
- If the fuel filler cap is not tightened properly, the MIL will come on. Be sure the cap is tightened every time the vehicle is refueled.

JACKING AND TIRE CHANGING

PREPARATIONS FOR JACKING

1. Park on a firm, level surface (avoid ice or slippery areas).

WARNING!

Do not attempt to change a tire on the side of the vehicle close to moving traffic. Pull far enough off the road to avoid being hit when operating the jack or changing the wheel.

2.  Turn on the Hazard Warning Flashers.
3. Apply the parking brake.
4. Place the ignition to the OFF position.
5. Block both the front and rear of the wheel diagonally opposite of your jacking position. For example, if the driver's front wheel is being changed, block the passenger's rear wheel.

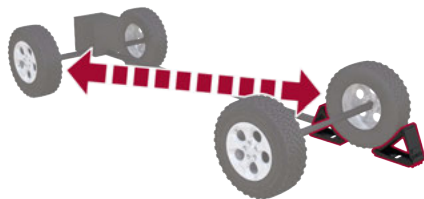

Wheel Blocked

NOTE:

- Passengers should not remain in the vehicle when the vehicle is being raised or lifted.
- Do not attempt to change a tire on the side of the vehicle close to moving traffic. Pull far enough off the road to avoid being hit when operating the jack or changing the wheel.

JACK LOCATION

The jack and tools are stored under the right rear seat.

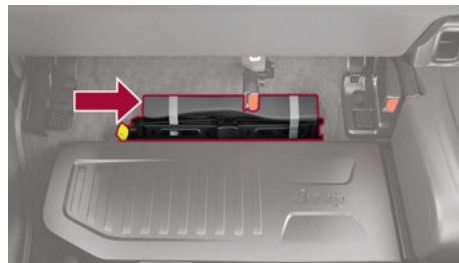

Jack And Tool Location

1. Fold up the right rear seat.
2. Remove the jack and tools by turning the wing bolt counterclockwise, remove the wing bolt and then slide the assembly out from under the seat.
3. Release the tool bag straps from the jack and remove tools from bag.
4. Remove tool kit and assemble tools.

SPARE TIRE LOCATION AND REMOVAL

Remove the spare tire before attempting to jack up the truck. The spare tire is secured under the rear of the vehicle with a winch and cable mechanism.

1. Locate the winch access hole at the rear of the vehicle.

2. Attach the lug wrench to the extension tubes with the curved angle facing away from the vehicle. Insert the extension tube through the access hole between the lower tailgate and the top of the fascia/bumper and into the winch mechanism tube.



Winch Mechanism Tube

3. Rotate the lug wrench handle counterclockwise until the spare tire is on the ground with enough cable slack to allow you to pull it out from under the vehicle.

CAUTION!

The winch mechanism is designed for use with the jack wrench extension tool only. Use of air wrench or power tool may damage the winch.

4. Pull the spare tire out from under the vehicle to gain access to the spare tire retainer.
5. Lift the spare tire with one hand to give clearance to tilt the retainer at the end of the cable.
6. Pull the retainer through the center of the wheel.

JACKING INSTRUCTIONS

WARNING!

Carefully follow these tire changing warnings to help prevent personal injury or damage to your vehicle:

- Always park on a firm, level surface as far from the edge of the roadway as possible before raising the vehicle.
- Turn on the Hazard Warning Flashers.
- Apply the parking brake firmly and shift an automatic transmission into PARK; a manual transmission into REVERSE.
- Block the wheel diagonally opposite the wheel to be raised.
- Never start or run the engine with the vehicle on a jack.
- Do not let anyone sit in the vehicle when it is on a jack.

(Continued)

WARNING!

- Do not get under the vehicle when it is on a jack. If you need to get under a raised vehicle, take it to a service center where it can be raised on a lift.
- Only use the jack in the positions indicated and for lifting this vehicle during a tire change.
- If working on or near a roadway, be extremely careful of motor traffic.
- To assure that spare tires, flat or inflated, are securely stowed, spares must be stowed with the valve stem facing the ground.
- No person should place any portion of their body under a vehicle that is supported by a jack.



Jack Warning Label

1. Remove the spare tire, jack and tools from the stored location.
2. Loosen (but do not remove) the wheel lug nuts by turning them counterclockwise one turn, while the wheel is still on the ground.
3. Assemble the jack and jacking tools. Connect the jack handle driver to the extension, then to the lug wrench.

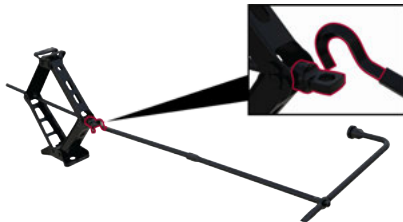

Assembled Jack And Tools

NOTE:

If your vehicle comes with factory equipped 35 inch (88.9 cm) tires, a jack lift block is provided in the rear cargo area. The jack lift block is used to provide higher ground clearance when changing a flat or spare tire. When placing the jack lift block under the jack, be sure the bottom of the jack fits securely inside of the raised edges of the block.

4. Operate the jack from the front or the rear of the vehicle. Place the jack under the axle tube, as shown. **Do not raise the vehicle until you are sure the jack is fully engaged.**

NOTE:

Keep the jack and tools aligned while raising the vehicle to prevent tool damage.

CAUTION!

Do not attempt to raise the vehicle by jacking on locations other than those indicated.

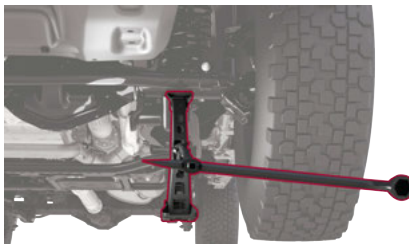

Front Jacking Location

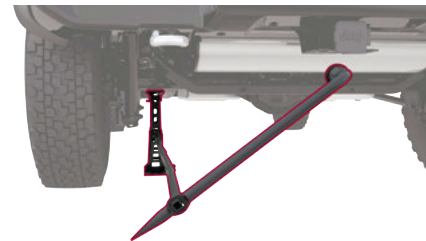

Rear Jacking Location

5. Raise the vehicle by turning the jack screw clockwise. Raise the vehicle only until the tire just clears the surface and enough clearance is obtained to install the spare tire. Minimum tire lift provides maximum stability.

WARNING!

Raising the vehicle higher than necessary can make the vehicle less stable. It could slip off the jack and hurt someone near it. Raise the vehicle only enough to remove the tire.

6. Remove the lug nuts and wheel.
7. Mount the spare tire on the axle.
8. Install the lug nuts with the cone-shaped end toward the wheel. Lightly tighten the lug nuts clockwise.

WARNING!

To avoid the risk of forcing the vehicle off the jack, do not tighten the wheel nuts fully until the vehicle has been lowered. Failure to follow this warning may result in serious injury.

- Lower the vehicle by turning the jack screw to the counterclockwise, and remove the jack.
- Finish tightening the wheel bolts. Push down on the wrench while at the end of the handle for increased leverage. Tighten the wheel bolts in a star pattern until each wheel bolt has been tightened twice. If in doubt about the correct tightness, have them checked with a torque wrench by an authorized dealer or at a service station.
- After 25 miles (40 km), check the lug nut torque with a torque wrench to ensure that all lug nuts are properly seated against the wheel.
- Remove the jack assembly and wheel blocks.
- Secure the jack and tools in their proper locations.

WARNING!

A loose tire or jack thrown forward in a collision or hard stop, could endanger the occupants of the vehicle. Always stow the jack parts and the spare tire in the places provided.

JUMP STARTING

If your vehicle has a discharged battery, it can be jump started using a set of jumper cables and a battery in another vehicle, or by using a portable battery booster pack. Jump starting can be dangerous if done improperly, so please follow the procedures in this section carefully.

WARNING!

Do not attempt jump starting if the battery is frozen. It could rupture or explode and cause personal injury.

CAUTION!

Do not use a portable battery booster pack or any other booster source with a system voltage greater than 12 Volts or damage to the battery, starter motor, alternator or electrical system may occur.

NOTE:

When using a portable battery booster pack, follow the manufacturer's operating instructions and precautions.

PREPARATIONS FOR JUMP STARTING

The battery in your vehicle is located in the left rear of the engine compartment.

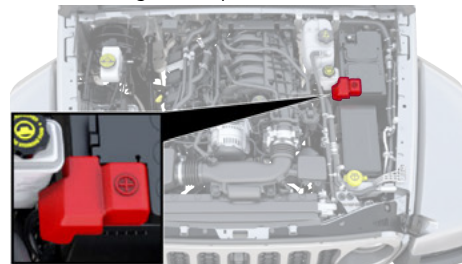

Positive (+) Battery Post Location

See the following steps to prepare for jump starting:

- Apply the parking brake, shift the automatic transmission into PARK (P) (manual transmission in NEUTRAL) and place the ignition in OFF mode.
- Turn off the heater, radio, and all electrical accessories.

3. Pull upward and remove the protective cover over the positive (+) battery post.
4. If using another vehicle to jump start the battery, park the vehicle within the jumper cable's reach, apply the parking brake and make sure the ignition is OFF.

WARNING!

- Do not allow vehicles to touch each other as this could establish a ground connection and personal injury could result.
- Take care to avoid the radiator cooling fan whenever the hood is raised. It can start anytime the ignition switch is ON. You can be injured by moving fan blades.
- Remove any metal jewelry such as rings, watch bands and bracelets that could make an inadvertent electrical contact. You could be seriously injured.
- Batteries contain sulfuric acid that can burn your skin or eyes and generate hydrogen gas which is flammable and explosive. Keep open flames or sparks away from the battery.

JUMP STARTING PROCEDURE

WARNING!

Failure to follow this jump starting procedure could result in personal injury or property damage due to battery explosion.

CAUTION!

Failure to follow these procedures could result in damage to the charging system of the booster vehicle or the discharged vehicle.

Connecting The Jumper Cables

1. Connect the positive (+) end of the jumper cable to the positive (+) post of the discharged vehicle.
2. Connect the opposite end of the positive (+) jumper cable to the positive (+) post of the booster battery.
3. Connect the negative (-) end of the jumper cable to the negative (-) post of the booster battery.
4. Connect the opposite end of the negative (-) jumper cable to a good engine ground. A "ground" is an exposed metallic/unpainted part of the engine, frame or chassis, such as an accessory bracket or large bolt. The

ground must be away from the battery and the fuel injection system.

WARNING!

Do not connect the jumper cable to the negative (-) post of the discharged battery. The resulting electrical spark could cause the battery to explode and could result in personal injury.

5. Start the engine in the vehicle that has the booster battery, let the engine idle a few minutes, and then start the engine in the vehicle with the discharged battery.

CAUTION!

Do not run the booster vehicle engine above 2,000 RPM since it provides no charging benefit, wastes fuel, and can damage booster vehicle engine.

6. Once the engine is started, follow the disconnecting procedure.

Disconnecting The Jumper Cables

1. Disconnect the negative (-) end of the jumper cable from the engine ground of the vehicle with the discharged battery.
2. Disconnect the opposite end of the negative (-) jumper cable from the negative (-) post of the booster battery.

3. Disconnect the positive (+) end of the jumper cable from the positive (+) post of the booster battery.
4. Disconnect the opposite end of the positive (+) jumper cable from the positive (+) post of the discharged vehicle.
5. Reinstall the protective cover over the positive (+) post of the discharged vehicle.

If frequent jump starting is required to start your vehicle you should have the battery and charging system tested at an authorized dealer.

CAUTION!

Accessories plugged into the vehicle power outlets draw power from the vehicle's battery, even when not in use (i.e., cellular devices, etc.). Eventually, if plugged in long enough without engine operation, the vehicle's battery will discharge sufficiently to degrade battery life and/or prevent the engine from starting.

FREED A STUCK VEHICLE

If your vehicle becomes stuck in mud, sand or snow, it can often be moved using a rocking motion. Turn the steering wheel right and left to clear the area around the front wheels. For vehicles with automatic transmission, push and

hold the lock button on the gear selector. Then, shift back and forth between DRIVE (D) and REVERSE (R), while gently pressing the accelerator. Use the least amount of accelerator pedal pressure that will maintain the rocking motion, without spinning the wheels or racing the engine.

NOTE:

- For vehicles with automatic transmission: Shifts between DRIVE (D) and REVERSE (R) can only be achieved at wheel speeds of 5 mph (8 km/h) or less. Whenever the transmission remains in NEUTRAL (N) for more than two seconds, you must press the brake pedal to engage DRIVE (D) or REVERSE (R).
- Push the ESC OFF button to place the Electronic Stability Control (ESC) system in "Partial OFF" mode, before rocking the vehicle. Once the vehicle has been freed, push the ESC OFF button again to restore "ESC On" mode.

WARNING!

Fast spinning tires can be dangerous. Forces generated by excessive wheel speeds may cause damage, or even failure, of the axle and tires. A tire could explode and injure someone. Do not spin your vehicle's wheels faster than

(Continued)

WARNING!

30 mph (48 km/h) or for longer than 30 seconds continuously without stopping when you are stuck and do not let anyone near a spinning wheel, no matter what the speed.

CAUTION!

- Racing the engine or spinning the wheels may lead to transmission overheating and failure. Allow the engine to idle with the transmission in NEUTRAL for at least one minute after every five rocking-motion cycles. This will minimize overheating and reduce the risk of clutch or transmission failure during prolonged efforts to free a stuck vehicle.
- When "rocking" a stuck vehicle by shifting between DRIVE/FIRST gear and REVERSE, do not spin the wheels faster than 15 mph (24 km/h), or drivetrain damage may result.
- Revving the engine or spinning the wheels too fast may lead to transmission overheating and failure. It can also damage the tires. Do not spin the wheels above 30 mph (48 km/h) while in gear (no transmission shifting occurring).

TOWING A DISABLED VEHICLE

This section describes procedures for towing a disabled vehicle using a commercial towing service.

If the transmission and drivetrain are operable, disabled 4x4 vehicles may also be towed as described.

Towing Condition	Wheels OFF The Ground	4WD MODELS
Flat Tow	NONE	NOT ALLOWED
Wheel Lift Or Dolly Tow	Front	NOT ALLOWED
	Rear	NOT ALLOWED
Flatbed	ALL	BEST METHOD
NOTE: When towing your vehicle, always follow applicable state and provincial laws. Contact state and provincial Highway Safety offices for additional details.		

Proper towing or lifting equipment is required to prevent damage to your vehicle. Use only tow bars and other equipment designed for this purpose, following equipment manufacturer's instructions. Use of safety chains is mandatory.

Attach a tow bar or other towing device to main structural members of the vehicle, not to fascia/bumpers or associated brackets. State and local laws regarding vehicles under tow must be observed.

If you must use the accessories (wipers, defrosters, etc.) while being towed, the ignition must be in the ON/RUN position, not the ACC position.

If the vehicle's battery is discharged, instructions on shifting the automatic transmission out of PARK (P) in order to move the vehicle.

CAUTION!
<ul style="list-style-type: none">Do not use sling type equipment when towing. Vehicle damage may occur.When securing the vehicle to a flatbed truck, do not attach to front or rear suspension components. Damage to your vehicle may result from improper towing.If the vehicle being towed requires steering, the ignition switch must be in the ACC or ON/RUN mode, not in the OFF mode.

TOWING IN AN EMERGENCY

Without The Key Fob

Special care must be taken when the vehicle is towed with the ignition in the OFF mode. The

only approved method of towing without the key fob is with a flatbed truck. Proper towing equipment is necessary to prevent damage to the vehicle.

Manual Park Release

In order to move the vehicle in cases where the transmission will not shift out of PARK (P) (such as a depleted battery), a Manual Park Release is available.

WARNING!
Always secure your vehicle by fully applying the parking brake before activating the Manual Park Release. In addition, you should be seated in the driver's seat with your foot firmly on the brake pedal when activating the Manual Park Release. Activating the Manual Park Release will allow your vehicle to roll away if it is not secured by the parking brake, or by proper connection to a tow vehicle. Activating the Manual Park Release on an unsecured vehicle could lead to serious injury or death for those in or around the vehicle.

See the following steps to use the Manual Park Release:

1. Firmly apply the parking brake.
2. Using a small screwdriver or similar tool, remove the manual park release cover

- located in front of the gear selector, to access the release tether strap.
3. Fish the tether strap up through the opening in the console base.
 4. Press and maintain firm pressure on the brake pedal.
 5. Pull the tether strap up until the release lever locks into place in the vertical position. The vehicle is now out of PARK (P) and can be moved. Release the parking brake only when the vehicle is securely connected to a tow vehicle.

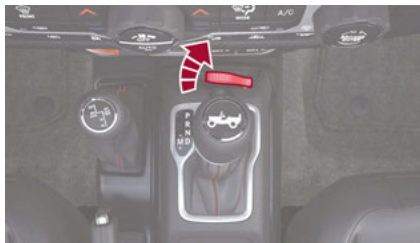

Vertical Released Position

To Reset The Manual Park Release:

1. Pull upward on the tether strap, releasing it from the “locked” position.

2. Lower the Manual Park Release lever downward and to the left, into its original position.
3. Tuck the tether strap into the base of the console, and reinstall the cover.

Emergency Tow Hooks — If Equipped

If your vehicle is equipped with tow hooks, they are mounted in the front and the rear fascia/bumpers.



Front Tow Hooks

NOTE:

Depending on vehicle trim level, rear tow hooks may vary.



Rear Tow Hook



Rear Tow Hooks

WARNING!

- Do not use a chain for freeing a stuck vehicle. Chains may break, causing serious injury or death.
- Stand clear of vehicles when pulling with tow hooks. Tow straps may become disengaged, causing serious injury.

CAUTION!

- Tow hooks are for emergency use only, to rescue a vehicle stranded off road. Tow straps are recommended when towing the vehicle, chains may cause vehicle damage.
- The tow hooks must not be used to move the vehicle off the road or where there are obstacles.
- Do not use the tow hooks for tow truck hookup or highway towing.
- Do not use the tow hooks to pull a vehicle onto a flatbed truck.
- Do not use the tow hooks to free a stuck vehicle ➞ page 38.
- Damage to your vehicle may occur if these guidelines are not followed ➞ page 39.

ENGINE COMPARTMENT OVERVIEW

3.6L ENGINE

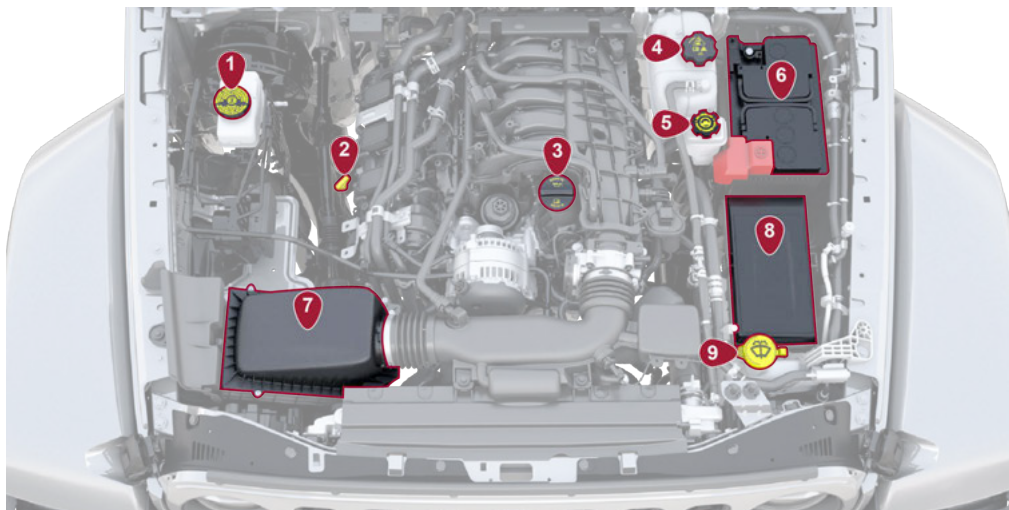

1 — Brake Fluid Reservoir Cap
2 — Engine Oil Dipstick
3 — Engine Oil Fill

4 — Engine Coolant Pressure Cap
5 — Power Steering Fluid Reservoir Cap
6 — Battery

7 — Engine Air Cleaner, Filter
8 — Power Distribution Center (Fuses)
9 — Washer Fluid Reservoir Cap

FLUID CAPACITIES

	US	Metric
Fuel (Approximate)	22.0 gal	83.0 L
Engine Oil with Filter		
3.6L Engine	5.0 qt	4.7 L
Cooling System (Includes coolant recovery bottle filled to MAX level)		
3.6L Engine	13.0 qt	12.3 L

ENGINE FLUIDS AND LUBRICANTS

Component	Fluid, Lubricant, or Genuine Part
Engine Coolant	We recommend using Mopar® Antifreeze/Coolant 10 Year/150,000 Mile (240,000 km) Formula OAT (Organic Additive Technology) or equivalent meeting the requirements of the manufacturer Material Standard MS.90032.
Engine Oil — 3.6L Gasoline Engine	We recommend using Mopar® SAE 0W-20 Full Synthetic Engine Oil which meets the requirements of the manufacturer Material Standard MS-6395. Equivalent full synthetic SAE 0W-20 engine oil can be used but must have the API Starburst trademark.
Fuel Selection — 3.6L Gasoline Engine	Minimum 91 Research Octane Number (RON).

CAUTION!

- Mixing of engine coolant (antifreeze) other than specified Organic Additive Technology (OAT) engine coolant (antifreeze), may result in engine damage and may decrease corrosion protection. Organic Additive Technology (OAT) engine coolant is different and should not be mixed with Hybrid Organic Additive Technology (HOAT) engine coolant (antifreeze) or any “globally compatible” coolant (antifreeze). If a non-OAT engine coolant (antifreeze) is introduced into the cooling system in an emergency, the cooling system will need to be drained, flushed, and refilled with fresh OAT coolant (conforming to MS.90032), by an authorized dealer as soon as possible.
- Do not use water alone or alcohol-based engine coolant (antifreeze) products. Do not use additional rust inhibitors or antirust products, as they may not be compatible with the radiator engine coolant and may clog the radiator.
- This vehicle has not been designed for use with propylene glycol-based engine coolant (antifreeze). Use of propylene glycol-based engine coolant (antifreeze) is not recommended.

CHASSIS FLUIDS AND LUBRICANTS

Component	Fluid, Lubricant, or Genuine Part
Automatic Transmission	Use only Mopar® ZF 8 & 9 Speed ATF Automatic Transmission Fluid or equivalent. Failure to use the correct fluid may affect the function or performance of your transmission.
Transfer Case	We recommend using Mopar® ATF+4 Automatic Transmission Fluid.
Front Axle Differential	We recommend using Mopar® Gear & Axle Lubricant (SAE 75W85) (API GL-5).
Rear Axle Differential (M220)	We recommend using Mopar® Gear & Axle Lubricant (SAE 75W85) (API GL-5). Models equipped with Trac-Lok Limited Slip Differential require a friction modifier additive.
Brake Master Cylinder	We recommend using Mopar® DOT 3 Brake Fluid, SAE J1703.
Power Steering Reservoir	We recommend using Mopar® Electric Steering Pump Fluid.

SERVICING AND MAINTENANCE

SCHEDULE SERVICING

Refer to the “Service And Warranty Handbook” for scheduled servicing.

OIL CHANGE RESET — IF EQUIPPED

- Your vehicle may be equipped with an engine oil change indicator system. The change oil message will display in the instrument cluster display for five seconds after a single chime has sounded, to indicate the next scheduled oil change. The engine oil change indicator system is duty cycle based, which means the engine oil change interval may fluctuate, depending upon your personal driving style.
- Unless reset, this message will continue to display each time the ignition is cycled to the ON/RUN position.

To reset the oil change indicator after performing the scheduled maintenance, refer to the following procedure:

1. Without pushing the brake pedal, place the ignition in the ON/RUN mode (do not start the engine).
2. Fully press the accelerator pedal, slowly, three times within ten seconds.

3. Without pushing the brake pedal, place the ignition in the OFF position.

NOTE:

If the indicator message illuminates when you start the vehicle, the oil change indicator system did not reset. If necessary, repeat this procedure.

ENGINE BREAK-IN RECOMMENDATIONS

A long break-in period is not required for the engine and drivetrain (transmission and axle) in your vehicle.

Drive moderately during the first 300 miles (500 km). After the initial 60 miles (100 km), speeds up to 50 or 55 mph (80 or 90 km/h) are desirable.

While cruising, brief full-throttle acceleration within the limits of local traffic laws contributes to a good break-in. You should avoid wide-open throttle acceleration in low gear as it can be detrimental.

The engine oil installed in the engine at the factory is a high-quality energy conserving type lubricant. Oil changes should be consistent with anticipated climate conditions under which vehicle operations will occur. For the recommended viscosity and quality grades ➡ page 43.

CAUTION!

Never use Non-Detergent Oil or Straight Mineral Oil in the engine or damage may result.

TRAILER TOWING WEIGHTS (MAXIMUM TRAILER WEIGHT RATINGS)

For trailer towing information (maximum trailer weight ratings) refer to the following website address: <https://www.jeep.com.au/gladiator.html>

A

Adaptive Cruise Control (ACC) (Cruise Control)	22
Air Conditioning	17
Android Auto	12
Antifreeze (Engine Coolant)	43
Automatic Headlights	20
Automatic High Beams	20
Automatic Temperature Control (ATC)	18
Automatic Transmission Fluid Type	44
Axle Fluid	44
Axle Lock	25, 26

B

Back Up Camera	30
Brake Fluid	44

C

Camera	30
Camera, Front	30
Camera, Rear	30
Capacities, Fluid	43
Caps, Filler Fuel	31
Oil (Engine)	42

Climate Control	17
Automatic	17

Cooling System Cooling Capacity	43
Selection Of Coolant (Antifreeze)	43
Cruise Control (Speed Control)	22
Customer Assistance	5

D

Defroster, Windshield	17
Dimmer Control Switch	20

E

Electrical Power Outlets	13
Emergency, In Case Of Jump Starting	36
Engine	42
Break-In Recommendations	45
Compartment	42
Coolant (Antifreeze)	43
Fuel Requirements	43
Jump Starting	36
Oil	43
Oil Filler Cap	42
Oil Selection	43
Exterior Lights	20

F

Filters Engine Oil	43
Fluid Capacities	43
Fluid, Brake	44
Fog Lights	20
Freeing A Stuck Vehicle	38
Front View Camera	30
Fuel Filler Cap (Gas Cap)	31
Octane Rating	43
Requirements	43
Specifications	43
Tank Capacity	43

G

Gas Cap (Fuel Filler Cap)	31
---------------------------------	----

H

Headlights Switch	20
----------------------------	----

I

Instrument Cluster	15
Descriptions	15

Inverter	
Power	14

J

Jack Location	33
Jack Operation	34
Jacking Instructions	34
Jump Starting	36

K

Keyless Enter'n Go™	10
---------------------------	----

L

Lights	
Exterior	20
Fog	20
Headlights	20
Locking	
Axle	25, 26

M

Manual Park Release	39
Media Hub	14
MP3 Control	14

N

New Vehicle Break-In Period	45
-----------------------------------	----

O

Octane Rating, Gasoline (Fuel)	43
Oil Change Indicator	
Reset	45
Oil, Engine	43
Capacity	43
Filter	43
Recommendation	43
Viscosity	43

P

Passive Entry	10
Power	
Inverter	14
Outlet (Auxiliary Electrical Outlet)	13
Seats	19
Power Steering Fluid	44

R

Radio	
Settings	11
Rear ParkSense System	24

S

Seats	
Power	19
Second Row USB	14
Selection Of Coolant (Antifreeze)	43
Service Assistance	5
Spare Tires	33
Specifications	
Fuel (Gasoline)	43
Oil	43
Speed Control (Cruise Control)	22
Steering	
Wheel, Voice Recognition	12
Stop/Start	10
Stuck, Freeing	38
Sway Bar Disconnect	
Electronic	27

T

Tailgate	31
Temperature Control, Automatic (ATC) ...	18
Tires	
Spare Tires	33
To Open Hood	30
Tow Hooks	
Emergency	40
Towing	39, 45

Disabled Vehicle	39
Weight	45
Trac-Lok	
Rear Axle	24
TrailCam System	30
Trailer Towing	
Trailer And Tongue Weight	45
Trailer Towing Guide	45
Trailer Weight	45
Transfer Case	
Fluid	44
Transmission	
Fluid	44

U

Uconnect	
Uconnect Settings	11
Uconnect Phone	11
Pair (Link) Uconnect Phone To A	
Mobile Phone	11
Uconnect System	11
USB	14

V

Vehicle Settings	11
Voice Command	12
Voice Recognition System (VR)	12

W

Warning Lights And Messages	16
Windshield Washers	21
Windshield Wipers	21

Be sure to follow all instructions in owner's manual for removal of top, doors and lowering of windshield. Driving with the doors off and windshield down is for off-road use only. FCA US LLC strongly recommends that the driver use extreme caution when using any device or feature that may take their attention off the road.



Jeep®



©2025 FCA US LLC. All Rights Reserved. Jeep is a registered trademark of FCA US LLC.
App Store is a registered trademark of Apple Inc. Google Play Store is a registered trademark of Google.

Second Edition
25_JT_OH_EN_AUS