



# WRANGLER

## 2025 OWNER HANDBOOK



Jeep®



Vehicle images are for illustration purposes only. Actual products sold may vary.

# WRANGLER

1

INTRODUCTION  
Page 4



2

INTERIOR  
Page 9



3

EXTERIOR  
Page 29



4

EMERGENCY  
Page 33



5

SPECIFICATIONS  
Page 44

# Jeep

6

INDEX  
Page 49

## INTRODUCTION

<b>OWNER HANDBOOK INTRODUCTION</b>	<b>4</b>
<b>SYMBOLS KEY</b>	<b>4</b>
<b>IF YOU NEED ASSISTANCE</b>	<b>5</b>
ARGENTINA	5
AUSTRALIA	5
BALANCE OF THE CARIBBEAN	5
BOLIVIA	5
BRAZIL	5
CHILE	6
CHINA	6
COLOMBIA	6
COSTA RICA	6
DOMINICAN REPUBLIC	6
ECUADOR	6
EL SALVADOR	6
EUROPE	6
GUATEMALA	7
HONDURAS	7
INDIA	7
JAPAN	7
NEW ZEALAND	7
PANAMA	7
PARAGUAY	8
PERU	8
PUERTO RICO AND U.S. VIRGIN ISLANDS	8
REUNION	8
SOUTH AFRICA	8
TAIWAN	8
URUGUAY	8
VENEZUELA	8

## INTERIOR

<b>INTERIOR OVERVIEW</b>	<b>9</b>
<b>STARTING AND OPERATING</b>	<b>10</b>
Keyless Enter 'n Go™ — Passive Entry	10
Stop/Start System	10
<b>MULTIMEDIA &amp; PHONE CONNECTIVITY</b>	<b>11</b>
Uconnect System	11
Uconnect Settings	11
Pair/Delete A Device	11
Apple CarPlay®	12
Android Auto™	12
Uconnect Voice Recognition — If Equipped	12
Off-Road Pages	12
<b>CHARGING &amp; OUTLETS</b>	<b>13</b>
Electrical Power Outlets	13
Power Inverters — If Equipped	14
USB	14
<b>INSTRUMENT CLUSTER</b>	<b>15</b>
Getting To Know Your Instrument Cluster	15
Instrument Cluster Display Location And Controls	16
Warning Lights And Messages	16
<b>INTERIOR COMFORT SETTINGS</b>	<b>17</b>
Climate Controls	17
Automatic Climate Control Descriptions And Functions	17
Automatic Temperature Control (ATC)	18
Climate Voice Recognition	18
Front Heated Seats — If Equipped	18

Power Front Seats Adjustment	18
Head Restraints	19
<b>LIGHTING OPERATION</b>	<b>20</b>
Headlight Switch	20
Automatic High Beams	21
Automatic Headlights	21
<b>WINDSHIELD WIPERS &amp; WASHERS</b>	<b>21</b>
Windshield Wiper Operation	21
<b>CRUISE CONTROL SYSTEM</b>	<b>22</b>
Adaptive Cruise Control (ACC)	22
<b>PARKING ASSISTANCE</b>	<b>24</b>
ParkSense Rear Park Assist System	24
<b>OFFROAD FEATURES</b>	<b>24</b>
Trac-Lok Rear Axle — If Equipped	24
Axle Lock (Tru-Lok) Front And Rear — If Equipped	25
Axle Lock (Tru-Lok) Rear Only — If Equipped	25
Axle Lock (Tru-Lok) Rear Only For High Speed Operation — If Equipped	26
Electronic Sway Bar Disconnect — If Equipped	27
Off Road+ — If Equipped	27

## EXTERIOR

<b>EXTERIOR OVERVIEW</b>	<b>29</b>
<b>EXTERIOR CAMERA VIEWS</b>	<b>30</b>
Back Up Camera	30
<b>HOOD</b>	<b>30</b>
To Open The Hood	30

To Close The Hood .....	31
<b>REFUELING THE VEHICLE .....</b>	<b>31</b>

## EMERGENCY

<b>SOS - EMERGENCY CALL — IF EQUIPPED ...</b>	<b>33</b>
<b>JACKING AND TIRE CHANGING .....</b>	<b>35</b>
Preparations For Jacking .....	35
Jack Location .....	36
Spare Tire Removal .....	36
Jacking Instructions .....	36
<b>JUMP STARTING— GAS MODELS .....</b>	<b>38</b>
Preparations For Jump Starting — Gas Models.....	38
Jump Starting Procedure — Gas Models ...	39
<b>FREEING A STUCK VEHICLE .....</b>	<b>40</b>
<b>TOWING A DISABLED VEHICLE .....</b>	<b>41</b>
Towing In An Emergency .....	41

## SPECIFICATIONS

<b>ENGINE COMPARTMENT OVERVIEW .....</b>	<b>44</b>
2.0L Engine.....	44
<b>FLUID CAPACITIES .....</b>	<b>45</b>
<b>ENGINE FLUIDS AND LUBRICANTS .....</b>	<b>45</b>
<b>CHASSIS FLUIDS AND LUBRICANTS .....</b>	<b>47</b>
<b>SERVICING AND MAINTENANCE .....</b>	<b>47</b>
Scheduled Servicing .....	47
Oil Change Reset .....	47
Engine Break-In Recommendations.....	48

<b>TRAILER TOWING .....</b>	<b>48</b>
Trailer Towing Weights (Maximum Trailer Weight Ratings) .....	48

# OWNER HANDBOOK INTRODUCTION

Thank you for choosing Jeep®. This Owner Handbook has been prepared to help you quickly become acquainted with important features of your vehicle. It contains most things you will need to operate and maintain your vehicle, including emergency information.

This handbook illustrates and describes the operation of certain features and equipment that come either standard or optional on your vehicle. It may include a description of features and equipment that your vehicle is not equipped with. FCA International Operations LLC (FCAIO) reserves the right to make changes in design and specifications and/or make additions to or improvements to its products without imposing any obligation upon itself to install them on products previously manufactured.





FCA International Operations LLC is committed to protecting the environment and invites you to scan this QR code to access the complete Owner's Manual.

**NOTE:**

For more information, please refer to your Consumer Information Guide, and complete Owner's Manual, available online.

# SYMBOLS KEY

<b>WARNING!</b>	These statements apply to operating procedures that could result in a collision, bodily injury and/or death.
<b>CAUTION!</b>	These statements apply to procedures that could result in damage to your vehicle.
<b>NOTE:</b>	A suggestion which will improve installation, operation, and reliability. If not followed, may result in damage.
<b>TIP:</b>	General ideas/solutions/suggestions on easier use of the product or functionality.
 <b>PAGE REFERENCE ARROW</b>	Follow this reference for additional information on a particular feature.
 <b>FOOTNOTE</b>	Supplementary and relevant information pertaining to the topic.

If you do not read the entire Owner's Manual, you may miss important information. Observe all Cautions and Warnings.



## IF YOU NEED ASSISTANCE

(\*) Customer Service offers information and assistance on products, services, dealerships and 24H Roadside Assistance. It can be contacted from the main European countries by calling the Universal Toll Free Number. In case of problems, please use the Local Toll Free Number or the International Toll Number.

FCAIO's distributors are vitally interested in your satisfaction with their products and services. If a servicing problem or other difficulty should occur, we recommend that you take the following steps:

Discuss the problem at the authorized dealer with the dealer principal or the service manager. Management personnel at the authorized dealer are in the best position to resolve the problem.

When you contact the distributor please provide all of the following information:

- Your name, address and phone number.
- Vehicle Identification Number (this 17-digit number is found on a label, located on the left front corner of the instrument panel, visible through the windshield. It is also available from your vehicle registration or title).
- Selling and servicing authorized dealer.
- Vehicle's delivery date and current odometer distance.

- Service history of your vehicle.
- An accurate description of the problem and the conditions under which it occurs.

## ARGENTINA

### Customer Care RSA Support 24hs (Chrysler, Jeep®, Dodge & Ram)

FCA Automobiles Argentina S.A.

Carlos Maria Della Paolera 299

Piso 25 Caba

Buenos Aires, Argentina

Local Toll Free Number Tel: 0 800 333 7070  
(option: 1)

## AUSTRALIA

Stellantis (Australia and New Zealand) Pty. Ltd.

ABN 23 125 956 505

PO Box 23267, Docklands Victoria 3008

Tel: 1300 133 079

## BALANCE OF THE CARIBBEAN

Interamericana Trading Corporation

Warrens, St. Michael

Barbados, West Indies

BB22026, PO Box 98

Tel.: 246-417-8000

Fax: 246-425-2888

## BOLIVIA

Ovando & Cia S.A.

Av. Cristobal de Mendoza (2do Anillo) y Canal Isuto

Santa Cruz, Bolivia

PO Box 6852

Tel.: (591-3) 336 3100

Fax: (591-3) 334 0229

## BRAZIL

FCA FIAT® CHRYSLER AUTOMÓVEIS BRASIL LTDA

Contorno Avenue, 3455 - Paulo Camilo, Betim - MG, 32669-900

Tel: +55 0800 703 7150

## CHILE

Comercial Fiat Chrysler SpA

Avenida Américo Vespucio Norte 1561, 8th floor.

Vitacura, Santiago. CHILE

Zip Code 101931-7, 367-V

Tel.: +562 25830990

Fax: +562 6039196

## CHINA

Shanghai Stellantis Automobile Company

8th floor, Building A2, Gumei Road

Shanghai

P.R. China

Zip Code 200233

Tel: 400-650-0118

## COLOMBIA

Automotriz Italoamerica

Of. Cr 45 # 108 - 27 Torre 3, Piso 12

Parallel Building 108

Bogota, D.C. | Colombia

Zip Code 111111

Tel: +57 (601) 519 0055

Fax: 01 8000 919 168

## COSTA RICA

AutoStar

La Uruca, frente al Banco Nacional

San José, Costa Rica

PO Box 705-1150

Tel.: (506) 295 - 0000

Fax: (506) 295 - 0052

## DOMINICAN REPUBLIC

Reid y Compañía

John F. Kennedy Casi Esq. Lope de Vega

Santo Domingo, Dominican Republic

Tel.: (809) 562-7211

Fax: (809) 565-8774

## ECUADOR

Corporacion Maresa, Distrivehic

Avenida De los Granados E11-67

Quito, Ecuador

Tel.: 593 1800 627 372

## EL SALVADOR

Grupo Q del Salvador

Ave. Las Amapolas (Autopista Sur)

Blvd. Los Próceres y Avenida No. 1, Lomas de San Francisco,

San Salvador, El Salvador

Zip Code 152

Tel.: +503 2248 6400

Fax: +503 278 5731

## EUROPE

### Jeep® Customer Service

The Jeep® Assistance Service for customers is available 24 hours a day, seven days a week. If you require assistance, see the provided contact information.

To access service from the UK, dial the telephone number then select option "Roadside Assistance"; if accessing the service from



abroad, select option "International Services" and select your language.

***Universal Toll Free Number\****

Tel: 00 800 0 426 5337

***Local Toll Free Number***

Tel: 0800 1692966

***International Toll Number***

Tel: +39 02 444 12 045

## **GUATEMALA**

Grupo Q del Guatemala

Km 16 carretera a El Salvador, condado concepción

Ciudad de Guatemala, Guatemala

Zip Code 1004

Tel.: +502 6685 9500

## **HONDURAS**

Grupo Q de Honduras

Blvd. Centro América frente a Plaza Miraflores,

Tegucigalpa, Honduras

Tel.: +504 2290 3700

Fax: +504 2232 6564

## **INDIA**

FCA India Automobiles Private Limited

Registered Office:

Giga space IT part, Delta One, 4th floor

Viman nagar, Pune- 411 014

Maharashtra

India

Tel: +91 20 30184500

Toll free: 1800-266-5337

Roadside Assistance: 1800-102-5337

## **JAPAN**

Jeep® Free Call

Local Toll Free Number

Tel: 0120-712-812

## **NEW ZEALAND**

Jeep® Customer Service

P O Box 12075, Penrose 1642

Auckland, New Zealand

Tel: +64 9 979 8000

## **PANAMA**

Automotora Autostar S.A.

Avenida Domingo Díaz, Vía Tocumen, Frente a la Urbanización El Crisol

Panamá, Panamá

Tel.: +507 233 7222

Fax: +507 233 2843

---

\* The Universal and UK telephone number is free for most calls from landlines and mobile phones. Calls from certain mobile phones and public telephones in some European countries may be charged according to the rates applied by the telephone operator. You are invited to check with the operator before proceeding. Each service must be authorized by the Jeep® Assistance Service. If you are unable to call the number, take the necessary actions and then inform the operator. In the latter case, expenses incurred will be reimbursed after providing appropriate receipts

## PARAGUAY

Garden Autolider S.A.

Av. República de Argentina esq. Facundo Machain

Asuncion, Paraguay

Tel.: +595 21 664 580

Fax: +595 21 664 579

## PERU

Divemotor S.A.

Av. Canada 1160, Urb. Sta. Catalina

Lima, Peru

Zip Code Lima 13

Tel.: (51-1) 712 2000

Fax: (51-1) 712 2002

## PUERTO RICO AND U.S. VIRGIN ISLANDS

FCA Caribbean LLC

P.O. Box 191857

San Juan 00919-1857

Phone: (877) 426-5337

## REUNION

COTRANS AUTOMOBILES

17 Bd du Chaudron, 97490 Sainte Clotilde

Tel: 0262920000

Fax: 0262488443

## SOUTH AFRICA

Jeep® Customer Service

Universal Toll Free Number

Tel: 8066727869

International Toll Free Number

Tel: +27102525000

## TAIWAN

Chrysler Taiwan Co., LTD.

13th Floor Union Enterprise Plaza

1109 Min Sheng East Road, Section 3

Taipei Taiwan R.O.C.

Tel.: 080081581

Fax: 886225471871

## URUGUAY

SEVEL Uruguay S.A.

Convenio 820

Montevideo, Uruguay

Zip Code 11700

Tel: +598 220 02980

Fax: +598 2209-0116

## VENEZUELA

FCA VENEZUELA, L.L.C.

PANCHO PEPE CROQUER ZONA INDUSTRIAL  
NORTE VALENCIA - VENEZUELA PLANTA  
CHRYSLER VALENCIA

RIF J-30357530-7 CÓDIGO POSTAL 2001

+58 424 44980678

+58 414 4222516

## INTERIOR OVERVIEW



1 — Uconnect Radio Screen Display ➞ page 11

2 — Instrument Cluster Display ➞ page 16

3 — Windshield Wipers and Washers ➞ page 21

4 — Climate Controls ➞ page 17

5 — Instrument Cluster Controls ➞ page 16

6 — USB/AUX Media Hub ➞ page 14

7 — Stop/Start Off Switch ➞ page 10

8 — Keyless Push Button Ignition

9 — Uconnect Voice Command Buttons ➞ page 12

10 — Cruise Control Buttons ➞ page 22

11 — Headlight Switch ➞ page 20

## STARTING AND OPERATING

### KEYLESS ENTER 'N GO™ — PASSIVE ENTRY

Keyless Enter 'n Go™ — Passive Entry allows you to lock and unlock the vehicle's door(s) and swing gate without having to push the key fob lock or unlock buttons.

#### To Unlock/Lock The Vehicle's Doors And Swing Gate

With a valid Passive Entry key fob with you, grab the handle to unlock the vehicle. The driver's handle will unlock the driver's door only (unless otherwise programmed in Uconnect Settings), whereas the passenger handle will unlock all doors and the swing gate.

With a valid Passive Entry key fob on you, push the Passive Entry lock button on the door handle to lock the vehicle and the swing gate.

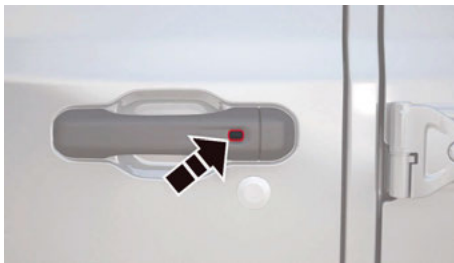

Push The Door Handle Button To Lock

#### NOTE:

- DO NOT grab the door handle when pushing the lock button. This could unlock the door(s).
- Be sure to keep the vehicle key fob with you.

### STOP/START SYSTEM

The Stop/Start function is designed to save fuel and reduce emissions. The system will stop the engine automatically during a vehicle stop if the required conditions are met. Releasing the brake pedal, pressing the accelerator pedal, or releasing the clutch pedal (on manual transmission) will automatically restart the engine.

The system must be in Stop/Start Ready state. A Stop/Start Ready message will be displayed in the instrument cluster display within the

Stop/Start section of Getting To Know Your Instrument Cluster.

### How To Turn Off The Stop/Start System

Did you know you can manually turn off your Stop/Start system?

Just push the Stop/Start OFF switch to turn off this feature. The light on the switch will illuminate and the "STOP/START OFF" message will appear in the instrument cluster display.



Stop/Start OFF Switch

#### NOTE:

The Stop/Start system will reset itself back to the on position every time the ignition is turned off and back on.

## MULTIMEDIA & PHONE CONNECTIVITY

### Uconnect SYSTEM



Uconnect 5/5 NAV Display

- 1 — Home Button
- 2 — Radio/Media Button
- 3 — Comfort Button
- 4 — Navigation Button (If Equipped)
- 5 — Phone Button
- 6 — Vehicle Button
- 7 — Apps Button

#### NOTE:

Uconnect screen images may not reflect the exact software in the vehicle.

### Uconnect SETTINGS



Uconnect 5/5 NAV With 12.3-inch Display Uconnect Settings

- 1 — Uconnect Buttons On The Touchscreen
- 2 — Uconnect Buttons On The Faceplate

Press the Vehicle button, then press the Settings button toward the top of the touchscreen to get started with customizing settings.

#### NOTE:

Depending on the vehicle's options, feature settings may vary.

- **Display** — Customize features such as display brightness or set navigation instructions to appear on the instrument cluster display.

- **Safety/Driving Assistance** — Customize settings such as the warning signal and steering wheel strength.
- **Phone/Bluetooth®** — Customize settings related to the paired device.
- **Camera** — Customize the vehicle's camera settings.
- **Seats & Comfort** — Customize comfort levels with heated seats or heated steering wheel.
- **Key Off Options** — Customize what the vehicle does when it shuts down.
- **Audio** — Customize audio settings.

### PAIR/DELETE A DEVICE

1. Make sure Bluetooth® is enabled on the mobile phone.
2. With the vehicle in the ACC or ON/RUN position, press the Phone button on the vehicle's touchscreen menu bar.
3. Press "Device Manager".
4. Select "Add Device".
5. Follow the prompts on the phone and on the touchscreen.

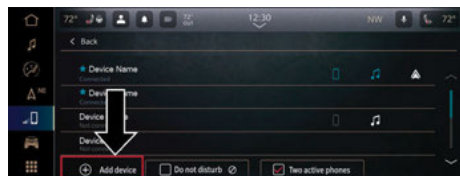

### Uconnect 5/5 NAV Pairing A Phone

Follow these steps to remove a smartphone:

1. Press the Device Manager button on the touchscreen.
2. Press the Settings gear icon next to the phone or device you wish to remove.
3. Press "Delete Device". The device should be removed.

### APPLE CARPLAY®

1. Ensure the iPhone® is unlocked for the very first connection, then ensure Siri is enabled in "Settings".
2. Connect the iPhone® to one of the media USB ports in the vehicle, or pair the iPhone® with the system. You have no need to plug the device in if it is paired with the system.
3. Once the device is connected and recognized, the Phone icon on the menu bar changes to the Apple CarPlay® icon.

### NOTE:

To use Apple CarPlay®, make sure cellular data is turned on and you are in an area with cellular coverage. Your data and cellular coverage is shown on the left side of the touchscreen within Apple CarPlay®. Data plan rates may apply.

### ANDROID AUTO™

1. Connect the phone to one of the media USB ports in the vehicle, or pair the phone with the system. It is not necessary to plug your device in if it is paired with the system.
2. Once the device is connected and recognized, the Phone icon on the menu bar changes to the Android Auto™ icon.

### NOTE:

To use Android Auto™, make sure you are in an area with cellular coverage. Android Auto™ may use cellular data, and your cellular coverage is shown in the upper right corner of the touchscreen. Data plan rates may apply.

### UCONNECT VOICE RECOGNITION — IF EQUIPPED

### Introduction

Follow the below steps to start using Uconnect Voice Recognition. They provide the key voice commands and tips you need to know to control the vehicle's VR system.

### Basic Voice Commands

The following basic voice commands can be given at any point while using the Uconnect system.

Push the VR button  or, for the Uconnect 5/5 NAV, say the vehicle's "Wake Up" word, "Hey, Uconnect". After the beep, say:

- "Cancel" to stop a current voice session.
- "Help" to hear a list of suggested Voice Commands.
- "Repeat" to listen to the system prompts again.

Notice the visual cues that inform you of the VR system's status on the Uconnect system.

### NOTE:

If your vehicle is not equipped with Voice Recognition, you may still have voice recognition buttons. These buttons will work with Android Auto™ and Apple CarPlay® by initiating a Siri or Google Assistant voice recognition session. Depending on your device, you may need to press and hold the VR button for one second to begin a voice recognition session.

### OFF-ROAD PAGES

Off-Road Pages is an application that provides vehicle status information while operation in off-road conditions. It supplies information relating

to the status of the drivetrain, transfer case, coolant/oil gauges, pitch and roll of the vehicle and access to the trailcam system.



### Uconnect 5/5 NAV Off-Road Pages

To access the Off-Road Pages:

1. Press the Vehicle button on the touchscreen and select "Dashboard".
2. Press "Off-Road Pages".
3. Press the desired button on the touchscreen to access that specific option within the Off-Road Pages.

## CHARGING & OUTLETS

### ELECTRICAL POWER OUTLETS

This vehicle may be equipped with a 12 Volt (13 Amp) power outlets that can be used to power cellular phones, small electronics, and other low powered electrical accessories.

The vehicle might have an outlet in any of the following locations:

- On the instrument panel, beneath the Climate Control buttons.
- On the trim in the rear cargo area.
- On the back of the center console.



### Instrument Panel Power Outlet

#### NOTE:

Power outlets labeled with a key symbol are powered when the ignition is in the ON/RUN position.

### WARNING!

To avoid serious injury or death:

- Only devices designed for use in this type of outlet should be inserted into any 12 Volt outlet.
- Do not touch with wet hands.
- Close the lid when not in use and while driving the vehicle.
- If this outlet is mishandled, it may cause an electric shock and failure.

### CAUTION!

- Power outlets are designed for accessory plugs only. Do not insert any other object in the power outlets as this will damage the outlet and blow the fuse. Improper use of the power outlet can cause damage not covered by your New Vehicle Limited Warranty.
- Many accessories that can be plugged in draw power from the vehicle's battery, even when not in use (i.e., cellular phones, etc.). Eventually, if plugged in long enough, the vehicle's battery will discharge sufficiently to degrade battery life and/or prevent the engine from starting.

*(Continued)*



### CAUTION!

- Accessories that draw higher power (i.e., coolers, vacuum cleaners, lights, etc.), will discharge the battery even more quickly. Only use these intermittently and with greater caution.
- After the use of high power draw accessories, or long periods of the vehicle not being started (with accessories still plugged in), the vehicle must be driven a sufficient length of time to allow the generator to recharge the vehicle's battery.

## POWER INVERTERS — IF EQUIPPED

There is a 230 V (400 W) maximum inverter outlet located on the back of the center console to convert Direct Current (DC) to Alternating Current (AC).



**Power Inverter**

### NOTE:

400 W is the maximum for the inverter, not each outlet. If two outlets are in use, 400 W is shared among the devices plugged in.

### WARNING!

To avoid serious injury or death:

- Do not insert any objects into the receptacles.
- Do not touch with wet hands.
- Close the lid when not in use.
- If this outlet is mishandled, it may cause an electric shock and failure.

## USB

The vehicle is equipped with two USB ports and one AUX port located on the instrument panel below the climate controls. The vehicle may also be equipped with USB ports located behind the center stack, above the power inverter.



**Front USB/AUX Ports**

- 1 — AUX Port
- 2 — USB Type C
- 3 — USB Type A

Plugging in a mobile device to a USB port below the Uconnect screen may activate the Android Auto™ or Apple CarPlay® features.

## INSTRUMENT CLUSTER

### GETTING TO KNOW YOUR INSTRUMENT CLUSTER



1. **Tachometer:**

Indicates the engine speed in revolutions per minute (RPM x 100).

2. **Temperature Gauge:**

The temperature gauge shows engine coolant temperature. Any reading within the normal range indicates that the engine is operating satisfactorily.

3. **Instrument Cluster Display:**

When the appropriate conditions exist, this display shows the instrument cluster display messages.

The display always shows one of the main menu items after ignition is placed on.

4. **Fuel Gauge:**

The gauge shows the level of fuel in the fuel tank when the Keyless Push Button Ignition is in the ON/RUN position.



The fuel pump symbol points to the side of the vehicle where the fuel door is located.

5. **Speedometer:** Indicates vehicle speed.

## INSTRUMENT CLUSTER DISPLAY LOCATION AND CONTROLS

The instrument cluster display is located in the center of the instrument cluster.

The system allows the driver to select information by pushing the instrument cluster display control buttons located on the left side of the steering wheel.



### Instrument Cluster Display Control Buttons

● **Left Arrow Button**

Push and release the **left** ◀ arrow button to access the information screens or submenu screens of a main menu item.

● **Up Arrow Button**

Push and release the **up** ▲ arrow button to scroll upward through the Main Menu items.

● **Right Arrow Button**

Push and release the **right** ▶ arrow button to access the information screens or submenu screens of a main menu item.

● **Down Arrow Button**

Push and release the **down** ▼ arrow button to scroll downward through the Main Menu items.

● **OK Button**

Push the **OK** button to access/select the information screens or submenu screens of a Main Menu item. Push and hold the **OK** arrow button for two seconds to reset displayed/selected features that can be reset.

## WARNING LIGHTS AND MESSAGES

Warning lights, indicators, and messages appear to signify various vehicle conditions. See the Quick Start Guide or Owner's Manual for examples and detailed descriptions. Some telltales are optional according to vehicle equipment.

## INTERIOR COMFORT SETTINGS

### CLIMATE CONTROLS

The Climate Control system allows you to regulate the temperature, air flow, and direction of air circulating throughout the vehicle.



Uconnect 5/5 NAV Automatic Climate Controls

### AUTOMATIC CLIMATE CONTROL DESCRIPTIONS AND FUNCTIONS

#### MAX A/C Button



Press the button on the touchscreen to set the system to maximum Air Conditioning (A/C).

#### A/C Button



Push the button to engage the Air Conditioning (A/C) system.

#### Recirculation Button



Push the button to change the system between Recirculation mode and outside air mode.

#### SYNC Button



Press the SYNC button on the touchscreen to synchronize the driver and front passenger temperature settings.

#### Auto Button

Push the AUTO Button after setting the desired temperature and the system will maintain the set temperature.

#### Front Defrost Button

Push the Front Defrost Button to change the current airflow setting to Defrost mode.

#### Rear Defrost Button

Push the Rear Defrost Button to turn on the rear window defroster and heated mirrors.

#### CAUTION!

Failure to follow these cautions can cause damage to the heating elements:

- Use care when washing the inside of the rear window. Do not use abrasive window cleaners on the interior surface of the window. Use a soft cloth and a mild washing solution, wiping parallel to the heating elements. Labels can be peeled off after soaking with warm water.
- Do not use scrapers, sharp instruments, or abrasive window cleaners on the interior surface of the window.
- Keep all objects a safe distance from the window.

### Driver And Passenger Temperature Controls

Push the driver or passenger's side toggle switch upward or downward, or slide the temperature bar to adjust the driver and passenger temperature settings.

### Blower Control

Use the small or large blower icon toggle switches or the blower bar on the touchscreen to increase or decrease the amount of air forced through the climate control system.

## Mode Control

Select Mode by pressing one of the Mode buttons on the touchscreen, or the faceplate, to change the airflow distribution mode.

## Climate Control OFF Button

Press the Off Button to turn the climate control system off.

## AUTOMATIC TEMPERATURE CONTROL (ATC)

### Automatic Operation

1. Push the AUTO button on the faceplate or the AUTO button on the touchscreen.
2. Select the desired temperature using the toggle switches or the touchscreen. The system then achieves and automatically maintains that comfort level.

### NOTE:

There will be no need for you to move the temperature settings for cold or hot vehicles. The system automatically adjusts the temperature, mode, and blower speed to provide comfort as quickly as possible.

### Manual Operation Override

Your Climate Control system includes manual override features. The AUTO symbol in the front

ATC display will turn off when the system is in the manual mode.

## CLIMATE VOICE RECOGNITION

You can adjust the vehicle's temperature hands-free while you're driving.

Push the VR button on the steering wheel. After the beep, say one of the following commands:

- "Set driver temperature to 20 degrees"
- "Set passenger temperature to 20 degrees"

## FRONT HEATED SEATS — IF EQUIPPED



The heated seat control buttons are located on the center instrument panel below the touchscreen and also in the Climate Control touchscreen menu.

Press the heated seat button to cycle through HI, MED, LO, and off settings.

### WARNING!

- Persons who are unable to feel pain to the skin because of advanced age, chronic illness, diabetes, spinal cord injury, medication, alcohol use, exhaustion or other physical condition must exercise care when using the seat heater. It may cause burns even at low temperatures, especially if used for long periods of time.

*(Continued)*

### WARNING!

- Do not place anything on the seat or seatback that insulates against heat, such as a blanket or cushion. This may cause the seat heater to overheat. Sitting in a seat that has been overheated could cause serious burns due to the increased surface temperature of the seat.

## POWER FRONT SEATS ADJUSTMENT

The power seat switch and power seat recline switch are located on the outboard side of the seat near the floor. Use the power seat switch to adjust seat height, angle, or forward/rearward position. Use the power seat recline switch to adjust the angle of the seatback.

Push the power lumbar switch forward to increase the lumbar support. Push the switch rearward to decrease the lumbar support. Pushing upward or downward on the switch will raise and lower the position of the support.



#### Power Seat Switches

- 1 — Power Lumbar Switch
- 2 — Power Seat Switch
- 3 — Power Recline Switch

#### WARNING!

Do not ride with the seatback reclined so that the shoulder belt is no longer resting against your chest. In a collision you could slide under the seat belt, which could result in serious injury or death.

## HEAD RESTRAINTS

Did you know your vehicle is equipped with front driver and passenger head restraints that can be adjusted two different ways?

Head restraints are designed to reduce the risk of injury by restricting head movement in the event of a rear impact. Head restraints should be adjusted so that the top of the head restraint is located above the top of your ear.



#### Head Restraint Buttons

- 1 — Removal Button
- 2 — Adjustment Button

- To raise the head restraint, pull upward on the head restraint.
- To lower the head restraint, push the adjustment button, located at the base of the head restraint, while pushing downward on the head restraint.

#### Rear Head Restraints - Two Door Vehicles

The rear seat is equipped with non-adjustable, but foldable head restraints.



#### Rear Outboard Head Restraint Strap

To fold the outboard head restraint, pull on the release strap located on the upper outboard side of each rear seat. To fold the outboard head restraint, pull on the release strap located on the upper outboard side of each rear seat.

#### Rear Head Restraints - Four Door Vehicles

The rear seat is equipped with nonadjustable, but foldable, outboard head restraints, as well as an adjustable, removable center head restraint.

## Outboard Head Restraints



### Rear Outboard Head Restraint Lever

To fold the outboard head restraint, pull on the inner release lever, located on the upper part of the rear seat. To return the head restraint to its upward position, lift up on the head restraint until it locks into place.

### Center Head Restraint

To raise the center head restraint, lift up on the head restraint. To lower the center head restraint, push the adjustment button, located at the base of the head restraint, and push down on the head restraint.

To remove the center head restraint, push the release button, located on the base of the head restraint, and pull upward on the head restraint.

To install the head restraint, hold the release button while pushing downward on the head restraint.

### WARNING!

- All occupants, including the driver, should not operate a vehicle or sit in a vehicle's seat until the head restraints are placed in their proper positions in order to minimize the risk of neck injury in the event of a crash.
- Head restraints should never be adjusted while the vehicle is in motion. Driving a vehicle with the head restraints improperly adjusted or removed could cause serious injury or death in the event of a collision.

## LIGHTING OPERATION

### HEADLIGHT SWITCH

The headlight switch is located on the left side of the instrument panel and is used to control your lighting.

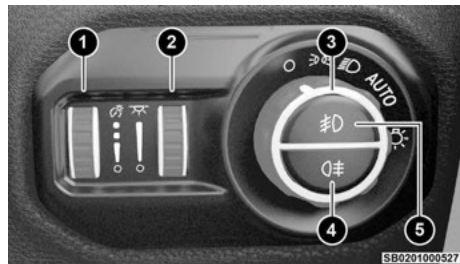

### Headlight Switch

- 1 — Instrument Panel Dimmer Control
- 2 — Ambient Light Dimmer Control (If Equipped)
- 3 — Headlight Control
- 4 — Rear Fog Light Switch
- 5 — Front Fog Light Switch

Rotate the headlight control knob to select one of the available positions: O (off), parking lights, headlights on, and AUTO headlights.



## AUTOMATIC HIGH BEAMS

Did you know your vehicle can automatically switch from high beams to low beams until an approaching vehicle is out of view?

The Automatic High Beam Headlight Control can be turned on or off by selecting “ON” under “Auto High Beam” within your Uconnect Settings, as well as turning the headlight switch to the AUTO position and placing the multifunction lever in the high beam position.

## AUTOMATIC HEADLIGHTS

With the engine running, make sure the headlight control knob is in the AUTO position; your vehicle will detect how bright it is outside and turn the headlights on/off as necessary.

## WINDSHIELD WIPERS & WASHERS

The windshield wiper/washer controls are located on the windshield wiper/washer lever on the right side of the steering column. The front wipers are operated by rotating a switch, located on the end of the lever.



Windshield Wiper/Washer Lever

## WINDSHIELD WIPER OPERATION

### Front Wipers

Rotate the end of the lever upward to the first detent past the intermittent settings for low-speed wiper operation.

Rotate the end of the lever upward to the second detent past the intermittent settings for high-speed wiper operation.

### Windshield Washers

To use the washer, pull the windshield wiper lever toward the steering wheel and hold.

### Mist

Push the lever upward to the MIST position and release for a single wiping cycle.

### NOTE:

The mist feature does not activate the washer pump; therefore, no washer fluid will be sprayed on the windshield. The washer function must be used in order to spray the windshield with washer fluid.

### Rear Wiper

Rotate the windshield wiper lever downward (without the vehicle in REVERSE) to activate/deactivate intermittent rear wiper operation.

### WARNING!

Sudden loss of visibility through the windshield could lead to a collision. You might not see other vehicles or other obstacles. To avoid sudden icing of the windshield during freezing weather, warm the windshield with the defroster before and during windshield washer use.

### CAUTION!

- Always remove any buildup of snow that prevents the windshield wiper blades from returning to the parked position. If the windshield wiper switch is turned off, and the blades cannot return to the parked position, damage to the wiper motor may occur.

*(Continued)*

#### CAUTION!

- In cold weather, always turn off the wiper switch and allow the wipers to return to the park position before turning off the engine. If the wiper switch is left on and the wipers freeze to the windshield, damage to the wiper motor may occur when the vehicle is restarted.

## CRUISE CONTROL SYSTEM

Your vehicle may be equipped with the Adaptive Cruise Control (ACC) system.

Adaptive Cruise Control (ACC) will adjust the vehicle speed up to the preset speed to maintain a distance with the vehicle ahead.

#### NOTE:

In vehicles equipped with ACC, if ACC is not enabled, Fixed Speed Cruise Control will not detect vehicles directly ahead of you. Only one Cruise Control feature can operate at a time.

### ADAPTIVE CRUISE CONTROL (ACC)

#### WARNING!

- Adaptive Cruise Control (ACC) is a convenience system. It is not a substitute

*(Continued)*

#### WARNING!

for active driver involvement. It is always the driver's responsibility to be attentive of road, traffic, and weather conditions, vehicle speed, distance to the vehicle ahead and, most importantly, brake operation to ensure safe operation of the vehicle under all road conditions. Your complete attention is always required while driving to maintain safe control of your vehicle. Failure to follow these warnings can result in a collision and death or serious personal injury.

- The ACC system:
  - Does not react to pedestrians, oncoming vehicles, and stationary objects (e.g., a stopped vehicle in a traffic jam or a disabled vehicle).
  - Cannot take street, traffic, and weather conditions into account, and may be limited upon adverse sight distance conditions.
  - Does not always fully recognize complex driving conditions, which can result in wrong or missing distance warnings.
  - Will bring the vehicle to a complete stop while following a vehicle ahead and hold the vehicle for two seconds in the stop position. If the vehicle ahead does not

*(Continued)*

#### WARNING!

start moving within two seconds the ACC system will display a message that the system will release the brakes and that the brakes must be applied manually. An audible chime will sound when the brakes are released.

- You should not utilize the ACC system:
  - When driving in fog, heavy rain, heavy snow, sleet, heavy traffic, and complex driving situations (i.e., in highway construction zones).
  - When entering a turn lane or highway off-ramp; when driving on roads that are winding, icy, snow-covered, slippery, or have steep uphill or downhill slopes.
  - When towing a trailer up or down steep slopes.
  - When circumstances do not allow safe driving at a constant speed.

The buttons on the right side of the steering wheel operate the Cruise Control and ACC systems.



### Adaptive Cruise Control Buttons

- 1 — Distance Setting Increase
- 2 — SET (+)/Accel
- 3 — CANCEL/Cancel
- 4 — RES/Resume
- 5 — ACC On/Off
- 6 — Fixed Speed Cruise Control On/Off
- 7 — Distance Setting Decrease
- 8 — SET (-)/Decel

#### ● To Activate/Deactivate

- Push and release the Adaptive Cruise Control (ACC) on/off button.

#### WARNING!

Leaving the Adaptive Cruise Control (ACC) system on when not in use is

*(Continued)*

#### WARNING!

dangerous. You could accidentally set the system or cause it to go faster than you want. You could lose control and have a collision. Always leave the system off when you are not using it.

#### ● To Set A Desired ACC Speed

- When the vehicle reaches the speed desired, push the SET (+) button or the SET (-) button and release. The instrument cluster display will show the set speed.

#### WARNING!

In Fixed Speed Cruise Control mode, the system will not react to vehicles ahead. In addition, the proximity warning does not activate and no alarm will sound even if you are too close to the vehicle ahead since neither the presence of the vehicle ahead nor the vehicle-to-vehicle distance is detected. Be sure to maintain a safe distance between your vehicle and the vehicle ahead. Always be aware which mode is selected.

#### ● To Deactivate

- To turn the system off, push and release the Adaptive Cruise Control (ACC) on/off

button again, or by placing your vehicle's ignition in the OFF position.

#### ● To Resume Speed

- If ACC was cancelled, and there is a set speed in memory, push the RES (resume) button.

#### WARNING!

The Resume function should only be used if traffic and road conditions permit. Resuming a set speed that is too high or too low for prevailing traffic and road conditions could cause the vehicle to accelerate or decelerate too sharply for safe operation. Failure to follow these warnings can result in a collision and death or serious personal injury.

#### ● To Vary The Speed Setting

- After setting a speed, you can increase the set speed by pushing the SET (+) button, or decrease speed by pushing the SET (-) button.

#### ● Setting The Following Distance In ACC

- To increase the distance setting, push the Distance Setting Increase button and release. Each time the button is pushed, the distance setting increases by one bar (longer).

- To decrease the distance setting, push the Distance Setting Decrease button and release. Each time the button is pushed, the distance setting decreases by one bar (shorter).

## PARKING ASSISTANCE

### ParkSense Rear Park Assist System

You can enable and disable the ParkSense system using the ParkSense switch, located in front of the center console, below the climate controls.



**ParkSense Switch**

#### WARNING!

- Drivers must be careful when backing up even when using ParkSense. Always check carefully behind your vehicle, look behind you, and be sure to check for pedestrians, animals, other vehicles, obstructions, and blind spots before backing up. You are responsible for safety and must continue to pay attention to your surroundings. Failure to do so can result in serious injury or death.
- Before using ParkSense, it is strongly recommended that the ball mount and hitch ball assembly be disconnected from the vehicle when the vehicle is not used for towing. Failure to do so can result in injury or damage to vehicles or obstacles because the hitch ball will be much closer to the obstacle than the rear fascia/bumper when the vehicle sounds the continuous tone. Also, the sensors could detect the ball mount and hitch ball assembly, depending on its size and shape, giving a false indication that an obstacle is behind the vehicle.

#### CAUTION!

- ParkSense is only a parking aid and it is unable to recognize every obstacle,

*(Continued)*

#### CAUTION!

including small obstacles. Parking curbs might be temporarily detected or not detected at all. Obstacles located above or below the sensors will not be detected when they are in close proximity.

- The vehicle must be driven slowly when using ParkSense in order to be able to stop in time when an obstacle is detected. It is recommended that the driver looks over his/her shoulder when using ParkSense.

## OFFROAD FEATURES

### TRAC-LOK REAR AXLE — IF EQUIPPED

The Trac-Lok rear axle provides a constant driving force to both rear wheels and reduces wheel spin caused by the loss of traction at one driving wheel. If traction differs between the two rear wheels, the differential automatically proportions the usable torque by providing more torque to the wheel that has traction.

Trac-Lok is especially helpful during slippery driving conditions. With both rear wheels on a slippery surface, a slight application of the accelerator will supply maximum traction.

### WARNING!

On vehicles equipped with a limited-slip differential, never run the engine with one rear wheel off the ground. The vehicle may drive through the rear wheel remaining on the ground and cause you to lose control of your vehicle.

## AXLE LOCK (TRU-LOK) FRONT AND REAR — IF EQUIPPED

The AXLE LOCK switch is located on the instrument panel (to the right of the steering column).

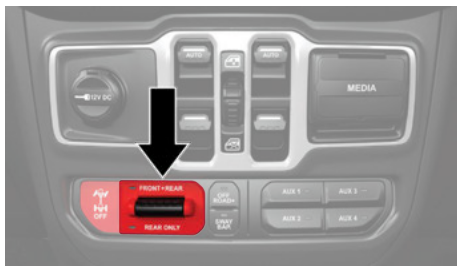

Axle Lock Switch Panel

This feature will only activate when the following conditions are met:

- Ignition in RUN position, vehicle in 4L (Four-Wheel Drive Low Range).
- Vehicle speed should be 10 mph (16 km/h) or less.
- Both right and left wheels on axle are at the same speed.

To activate the system, push the AXLE LOCK switch down to lock the rear axle only (the “REAR ONLY” will illuminate), push the switch up to lock the front axle and rear axle (the “FRONT + REAR” will illuminate). When the rear axle is locked, pushing the bottom of switch again will lock or unlock the front axle.

### NOTE:

The indicator lights will flash until the axles are fully locked or unlocked.

To unlock the axles, push the AXLE LOCK OFF button.

Axle Lock will disengage if the vehicle is taken out of 4L, or the ignition switch is turned to the OFF position.

## AXLE LOCK (TRU-LOK) REAR ONLY — IF EQUIPPED

The rear axle may be locked in 4H (Four-Wheel Drive High Range) if the proper conditions are met.

The AXLE LOCK switch is located on the instrument panel (to the right of the steering column).

### WARNING!

This mode is intended for off-highway or off-road use only and should not be used on any public roadways.

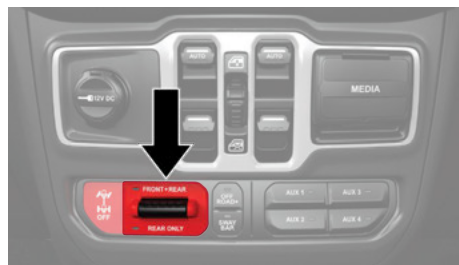

Axle Lock Switch Panel

This feature will only activate when the following conditions are met:

- Ignition in RUN position, vehicle in 4L (Four-Wheel Drive Low Range).
- Vehicle speed should be 10 mph (16 km/h) or less.
- Both right and left wheels on the axle are at the same speed.

To activate the rear system, push the AXLE LOCK switch down to lock the rear axle only (the “REAR ONLY” will illuminate).

**NOTE:**

The indicator lights will flash until the rear axle is fully locked or unlocked.

To unlock the axle, push the AXLE LOCK OFF button.

Axle lock will disengage if the vehicle is taken out of 4L.

The axle lock disengages at speeds above 30 mph (48 km/h), and will automatically re-lock once vehicle speed is less than 10 mph (16 km/h).

## AXLE LOCK (TRU-LOK) REAR ONLY FOR HIGH SPEED OPERATION — IF EQUIPPED

The rear axle may be locked in 4H for high speed vehicle operation if the proper conditions are met and if equipped with either Front and Rear or Rear Only axle lock.

### WARNING!

This mode is intended for off-highway or off-road use only and should not be used on any public roadways.

The AXLE LOCK switch is located on the instrument panel (to the right of the steering column).

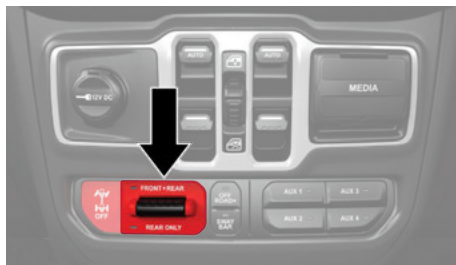

Axle Lock Switch Panel

This feature will only activate when the following conditions are met:

- Ignition in RUN position, vehicle in 4H (Four-Wheel Drive High Range).
- The vehicle must first be in Off Road+ active Off Road+ — If Equipped.
- Vehicle must then be placed in ESC “Full Off” mode ESC Operating Modes (please fully read all ESC Full Operation details).
- Vehicle must not be actively in a high wheel slip or tight cornering condition.

To activate the rear system, push the AXLE LOCK switch down to lock the rear axle only (the “REAR ONLY” will illuminate).

To unlock the axle, push the AXLE LOCK OFF button.

Axle lock will disengage if the vehicle is taken out of 4H (Four-Wheel Drive High Range), Off Road+ is turned off by the driver, ESC “Full Off” is exited, or the ignition switch is turned to the OFF position.

**NOTE:**

The indicator lights will flash until the rear axle is fully locked or unlocked.

The rear axle lock system may temporarily disengage the rear locker under some conditions.

If this occurs, the rear axle will automatically re-lock as soon as the system allows.

If an axle lock request cannot be completed by the system within 5 seconds due to vehicle operating conditions not being correct, the request will be canceled and the driver may need to re-request the locker to be activated.

## ELECTRONIC SWAY BAR DISCONNECT — IF EQUIPPED

Your vehicle may be equipped with an electronic disconnecting stabilizer/sway bar.



### SWAY BAR Switch

Push the SWAY BAR switch to activate the system. Push the switch again to deactivate the system. The Sway Bar Indicator Light (located in the instrument cluster) will illuminate when the bar is disconnected. The Sway Bar Indicator

Light will flash during activation transition, or when activation conditions are not met. The stabilizer/sway bar should remain in on-road mode during normal driving conditions.

### WARNING!

Ensure the stabilizer/sway bar is reconnected before driving on hard surfaced roads or at speeds above 18 mph (29 km/h); a disconnected stabilizer/sway bar may contribute to the loss of vehicle control, which could result in serious injury. Under certain circumstances, the front stabilizer/sway bar enhances vehicle stability and assists with vehicle control. The system monitors vehicle speed and will attempt to reconnect the stabilizer/sway bar at speeds over 18 mph (29 km/h). This is indicated by a flashing or solid Sway Bar Indicator Light. Once vehicle speed is reduced below 14 mph (22 km/h), the system will once again attempt to return to off-road mode.

### NOTE:

The stabilizer/sway bar may be torque locked due to left and right suspension height differences. This condition is due to driving surface differences or vehicle loading. In order for the stabilizer/sway bar to disconnect/reconnect, the right and left halves of the bar must be aligned. This alignment may require

that the vehicle be driven onto level ground or rocked from side to side.

### WARNING!

If the stabilizer/sway bar will not return to on-road mode, the Sway Bar Indicator Light will flash in the instrument cluster and vehicle stability may be reduced. Do not attempt to drive the vehicle over 18 mph (29 km/h). Driving faster than 18 mph (29 km/h) with a disconnected stabilizer/sway bar may contribute to the loss of vehicle control, which could result in serious injury.

## OFF ROAD+ — IF EQUIPPED

To activate Off Road+, push the OFF ROAD+ switch in the switch bank when in 4WD.

When Off Road+ is active, the following features will activate:

- The Off Road+ telltale will illuminate in the instrument cluster display
- A mode-specific message will display the instrument cluster display
- Off-Road Pages will launch on the radio head-unit if selected in radio settings
- The TrailCam System will launch if selected in radio settings





### **OFF ROAD+ Switch**

Once in Off Road+, the vehicle will begin to behave in different ways depending on the 4WD mode in use.

## EXTERIOR OVERVIEW



1 — Swing Gate Release Button

2 — Exterior Camera Locations ➞ page 30

3 — Emergency Tow Hook ➞ page 41

## EXTERIOR CAMERA VIEWS

### BACK UP CAMERA

The ParkView Rear Back Up Camera allows you to see an on-screen image of the rear surroundings of your vehicle whenever the gear selector is put into REVERSE.

#### Manual Activation Of The Rear View Camera:

1. Press the Vehicle button located on the Uconnect display and then select the Camera tab.
2. Press the Back Up Camera button to turn the Rear View Camera system on.

#### WARNING!

Drivers must be careful when backing up even when using the ParkView Rear Back Up Camera. Always check carefully behind your vehicle, and be sure to check for pedestrians, animals, other vehicles, obstructions, or blind spots before backing up. You are responsible for the safety of your surroundings and must continue to pay attention while backing up. Failure to do so can result in serious injury or death.

#### CAUTION!

- To avoid vehicle damage, ParkView should only be used as a parking aid. The ParkView camera is unable to view every obstacle or object in your drive path.
- To avoid vehicle damage, the vehicle must be driven slowly when using ParkView to be able to stop in time when an obstacle is seen. It is recommended that the driver look frequently over his/her shoulder when using ParkView.

## HOOD

### To Open The Hood

#### WARNING!

- **For Hybrid models:** Always place the power button in the OFF position before opening the hood.
- Some areas remain very hot for a while after driving or charging and may cause serious burns if touched.
- Keep hands, tools, clothing, and jewelry away from the radiator cooling fan when the hood is raised. The cooling fan may start operating at any time, including during

(Continued)

#### WARNING!

charging. Hands or clothing caught in a rotating fan may cause serious injury.

To open the hood:

1. Release both of the outside hood latches.
2. Raise the hood slightly, and place a hand palm-side down in the center of the hood opening. Locate the safety latch in the middle, and push the latch to the right to open.

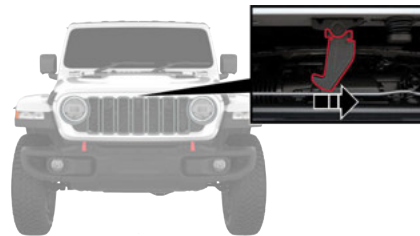

#### Safety Latch Location

3. Remove the support rod from the hood, and insert it into the radiator crossmember.

#### NOTE:

- Vehicle must be at a stop and the gear selector must be in PARK.

- Before lifting the hood, check that the wiper arms are not in motion and not in the lifted position.
- While lifting the hood, use both hands.
- You may have to push down slightly on the hood before pushing the safety latch.

#### WARNING!

Be sure the hood is fully latched before driving your vehicle. If the hood is not fully latched, it could open when the vehicle is in motion and block your vision. Failure to follow this warning could result in serious injury or death.

#### CAUTION!

To prevent possible damage, do not slam the hood to close it.

### To Close The Hood

To close the hood, remove the support rod from the slot and replace it on the hood panel retaining clip. Lower the hood slowly. Secure both of the hood latches.

#### WARNING!

Be sure the hood is fully latched before driving your vehicle. If the hood is not fully latched, it

*(Continued)*

#### WARNING!

could open when the vehicle is in motion and block your vision. Failure to follow this warning could result in serious injury or death.

#### CAUTION!

To prevent possible damage, do not slam the hood to close it.

## REFUELING THE VEHICLE

The fuel filler cap is located on the driver's side of the vehicle. If the fuel filler cap is lost or damaged, be sure the replacement cap is the correct one for this vehicle.

1. Open the fuel filler door.
2. Remove the fuel cap by rotating it counterclockwise.

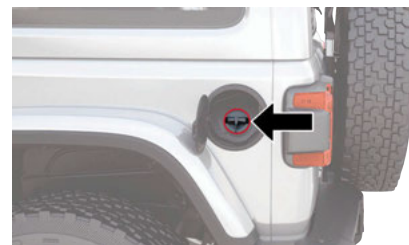

**Fuel Filler Cap**

3. Fully insert the fuel nozzle into the filler pipe.
4. Fill the vehicle with fuel.

#### NOTE:

- When the fuel nozzle “clicks” or shuts off, the fuel tank is full.
  - Wait five seconds before removing the fuel nozzle to allow excess fuel to drain from the nozzle.
5. Remove the fuel nozzle, reinstall fuel cap and close fuel filler door.

#### WARNING!

- Never have any smoking materials lit in or near the vehicle when the fuel door is open or the tank is being filled.

*(Continued)*

### WARNING!

- A fire may result if fuel is pumped into a portable container that is inside of a vehicle. You could be burned. Always place fuel containers on the ground while filling.

### CAUTION!

- Damage to the fuel system or emission control system could result from using an improper fuel filler cap. A poorly fitting cap could let impurities into the fuel system. Also, a poorly fitting aftermarket cap can cause the Malfunction Indicator Light (MIL) to illuminate, due to fuel vapors escaping from the system.
- To avoid fuel spillage and overfilling, do not “top off” the fuel tank after filling.

### NOTE:

- When the fuel nozzle “clicks” or shuts off, the fuel tank is full.
- Tighten the fuel filler cap about a quarter turn until you hear one click. This is an indication that the cap is properly tightened.
- If the fuel filler cap is not tightened properly, the MIL will come on. Be sure the cap is tightened every time the vehicle is refueled.

## SOS - EMERGENCY CALL — IF EQUIPPED

Your vehicle has an on-board assistance feature that is designed to provide support in case of accident and/or emergency. This feature is automatically activated by air bag intervention, or can be activated manually by pushing the button located on the overhead console.

### NOTE:

SOS-Emergency Call will only work with an enabled network operator.

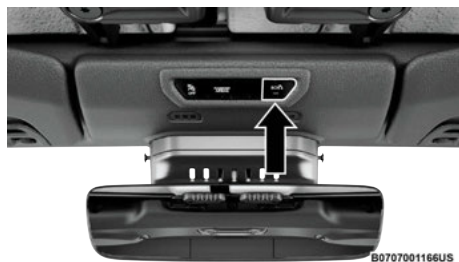

**SOS-Emergency Call Button**

The SOS-Emergency Call system automatically forwards a call to emergency services in the event of an accident with air bag intervention providing that the ignition device is in the RUN

position and the air bags are working. Pressing the SOS button on the overhead console will illuminate the light within the button. When the connection between the vehicle and a public safety operator is made, your vehicle will automatically transmit location and vehicle information to the emergency service operator.

Only a public safety operator can remotely end the SOS-Emergency Call and, if necessary, call the vehicle back through the Emergency Call system. Once the call has ended, you can still call the emergency service operator to indicate additional information by pushing the button again.

### To Use SOS-Emergency Call

Push and hold the SOS-Emergency Call button for a few seconds. The LED, located within the SOS button, will blink once and then stay on indicating a call has been placed.

### NOTE:

If the SOS-Emergency Call button is accidentally pushed, there is a 10 second delay before the call is placed. The system will issue a verbal alert that a call is about to be made. To cancel the call connection, push the SOS-Emergency Call button again.

Once a connection between the vehicle and an emergency service operator is made, the SOS-Emergency Call system will transmit the

following important vehicle information to the operator:

- Indication that the occupant placed an SOS-Emergency Call.
- The Vehicle Identification Number (VIN).
- The last known GPS coordinates of the vehicle.

You will then be able to speak with the emergency service operator to determine if additional help is needed.

The SOS-Emergency Call has priority over other audio sources, which will be muted. If you have a phone connected via Bluetooth®, it is disconnected and reconnected at the end of the SOS-Emergency Call. Voice prompts will guide you during the SOS-Emergency Call. If a connection is made between an emergency service operator and your vehicle, emergency service operators may record conversations and sounds within your vehicle once a connection is made, by using the service you consent to having this information shared.

### SOS-Emergency Call System Limitations

When the ignition switches to the RUN position, the Emergency Call system runs a routine check. During this check, a red indicator will illuminate for about three seconds. This signal must not be confused with a fault warning. In the event of a malfunction, the red indicator would remain

on. If the SOS-Emergency Call system detects a malfunction, any of the following may occur at the time the malfunction is detected:

- The LED within the SOS button will continuously illuminate red.
- The Emergency Call system is powered by its own non-rechargeable battery to ensure operation, even when the vehicle battery is discharged or disconnected. When system battery is discharged, the instrument cluster display will show a special message, different than other messages referring to other types of faults. In this case, the system works only if powered by the vehicle's battery.
- The instrument cluster will display a message alerting you to contact the Service Network along with a failure warning light.

Even if the SOS-Emergency Call system is fully functional, external or uncontrolled factors may prevent or stop SOS-Emergency Call operation. These include, but are not limited to, the following factors:

- The ignition is in OFF position.
- The vehicle's electrical systems are not intact.
- The SOS-Emergency Call system software and/or hardware is damaged during a vehicle collision.

- There are network problems that could limit or impair service operation (e.g., error by operator, busy network, bad weather, etc.).

If the vehicle battery connection fails due to a collision or accident, the system can support an SOS-Emergency Call for a limited period of time. If the battery is disconnected for service, the system turns off. In this case, it will be possible to make an SOS-Emergency Call only when the battery is reconnected to the vehicle's electrical system.

#### System Requirements

- Vehicle must have an operable 3G network connection.
- Vehicle must be powered with a properly functioning electrical system.
- The ignition must be in the ON/RUN or ACC position.

#### WARNING!

- Never place anything on or near the vehicle's 3G and GPS aerials. You could prevent 3G and GPS signal reception, which can prevent your vehicle from placing an emergency call. An operable 3G network connection and a GPS signal is required for

(Continued)

#### WARNING!

the SOS-Emergency Call system to function properly.

- Do not add any aftermarket electrical equipment to the vehicle's electrical system. This may prevent your vehicle from sending a signal to initiate an emergency call. To avoid interference that can cause the SOS-Emergency Call system to fail, never add aftermarket equipment (e.g., two-way mobile radio, CB radio, data recorder, etc.) to your vehicle's electrical system or modify the antennas on your vehicle. IF YOUR VEHICLE LOSES BATTERY POWER FOR ANY REASON (INCLUDING DURING OR AFTER AN ACCIDENT) THE MTC+ FEATURES, APPS AND SERVICES AMONG OTHERS WILL NOT OPERATE.
- The Occupant Restraint Controller (ORC) turns on the air bag warning light in the instrument cluster if a malfunction in any part of the air bag system is detected. If the air bag warning light is illuminated, the air bag system may not be working properly and the SOS-Emergency Call system may not be able to send a signal to an emergency service operator. If the air bag warning light is illuminated, contact the

(Continued)



### WARNING!

Service Network to have the air bag system checked immediately.

- Ignoring the LED on the SOS-Emergency Call button could mean you will not have emergency call services if needed. If the LED on SOS-Emergency Call button is illuminated red, contact the Service Network to have the emergency call system checked immediately.
- If anyone in the vehicle could be in danger (e.g., fire or smoke is visible, dangerous road conditions or location), do not wait for voice contact from an emergency service operator. All occupants should exit the vehicle immediately and move to a safe location.
- Failure to perform scheduled maintenance and regularly inspect your vehicle may result in vehicle damage, accident or injury.

### Frequently Asked Questions:

#### What happens if I accidentally push the SOS-Emergency Call Button?

- You have 10 seconds after pushing the emergency button to cancel the call. To cancel the call, push the button again.

#### What type of information is sent when I make an SOS-Emergency Call from my vehicle?

- Certain vehicle information, such as the VIN, is transmitted along with last known GPS location. Also note that emergency service operators may record conversations and sounds within your vehicle once a connection is made, by using the service you consent to having this information shared.

#### When can I use the SOS-Emergency Call button?

-  The SOS-Emergency Call button should **ONLY** be used to make a call if you or someone else needs emergency assistance.

## JACKING AND TIRE CHANGING

### PREPARATIONS FOR JACKING

1. Park on a firm, level surface (avoid ice or slippery areas).
2.  Turn on the Hazard Warning Flashers.
3. Apply the parking brake.
4. Place the ignition to the OFF position.

5. Block both the front and rear of the wheel diagonally opposite of your jacking position. For example, if the driver's front wheel is being changed, block the passenger's rear wheel.

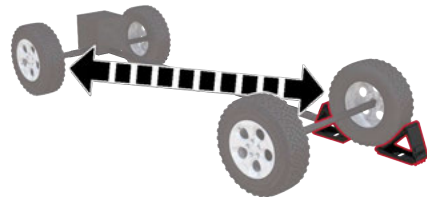

#### Wheel Blocked

#### NOTE:

- Passengers should not remain in the vehicle when the vehicle is being raised or lifted.
- Do not attempt to change a tire on the side of the vehicle close to moving traffic. Pull far enough off the road to avoid being hit when operating the jack or changing the wheel.

## JACK LOCATION

The jack and lug wrench are located in the rear cargo area. To remove jack and tools proceed as follows:

1. Lift the load floor in the cargo area.

### NOTE:

The load floor can be removed for easier access by pulling the load floor handle up and directly rearward.

2. Remove the hardware storage cover by pinching the latch on the left side and pulling upward.



### Hardware Storage Cover Latch

3. Turn the plastic wing nut counterclockwise to loosen the jack from the storage bin.
4. Remove tool kit and assemble tools.

## SPARE TIRE REMOVAL

1. To remove the spare tire from the carrier, remove the tire cover, if equipped.
2. Remove the Rear Camera Cover by turning the lock bolt counterclockwise with the #T40 torx head driver and ratchet from the supplied tool kit.
3. Remove the lug nuts with the lug wrench turning them counterclockwise. If equipped, remove the locking lug nut with the lock key (located in the glove box) turning it counterclockwise.

## JACKING INSTRUCTIONS

### WARNING!

Carefully follow these tire changing warnings to help prevent personal injury or damage to your vehicle:

- Always park on a firm, level surface as far from the edge of the roadway as possible before raising the vehicle.
- Turn on the Hazard Warning Flashers.
- Apply the parking brake firmly and shift an automatic transmission into PARK; a manual transmission into REVERSE.

(Continued)

### WARNING!

- Block the wheel diagonally opposite the wheel to be raised.
- Never start or run the engine with the vehicle on a jack.
- Do not let anyone sit in the vehicle when it is on a jack.
- Do not get under the vehicle when it is on a jack. If you need to get under a raised vehicle, take it to a service center where it can be raised on a lift.
- Only use the jack in the positions indicated and for lifting this vehicle during a tire change.
- If working on or near a roadway, be extremely careful of motor traffic.
- To assure that spare tires, flat or inflated, are securely stowed, spares must be stowed with the valve stem facing the ground.
- The jack is an emergency tool. It should not be used for maintenance. If you turn the jack handle too forcefully the connection between the jack handle bar and the jack may come off causing damage to the vehicle. Please work slowly and carefully.
- No person should place any portion of their body under a vehicle that is supported by a jack.

1. Remove the spare tire, jack and tools from the stored location.
2. Loosen (but do not remove) the wheel lug nuts by turning them to the left one turn while the wheel is still on the ground.
3. Assemble the jack and jacking tools. Connect the jack handle driver to the extension, then to the lug wrench.

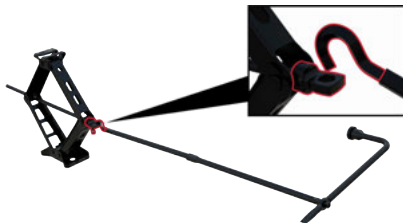

**Assembled Jack And Tools**

**NOTE:**

If your vehicle comes with factory equipped 35 inch (88.9 cm) tires, a jack lift block is provided in the rear cargo area. The jack lift block is used to provide higher ground clearance when changing a flat or spare tire. When placing the jack lift block under the jack, be sure the bottom of the jack fits securely inside of the raised edges of the block.

4. Operate the jack from the front or the rear of the vehicle. Place the jack under the axle tube, as shown. **Do not raise the vehicle until you are sure the jack is fully engaged.**

**NOTE:**

Keep the jack and tools aligned while raising the vehicle to prevent tool damage.

**CAUTION!**

Do not attempt to raise the vehicle by jacking on locations other than those indicated.

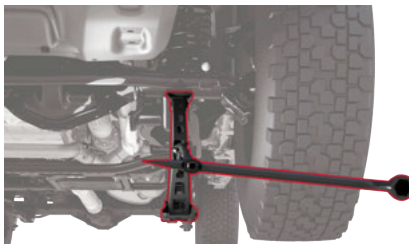

**Front Jacking Location**

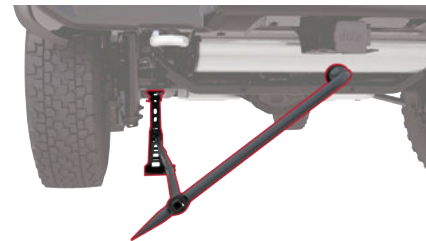

**Rear Jacking Location**

5. Raise the vehicle by turning the jack screw clockwise. Raise the vehicle only until the tire just clears the surface and enough clearance is obtained to install the spare tire. Minimum tire lift provides maximum stability.

**WARNING!**

Raising the vehicle higher than necessary can make the vehicle less stable. It could slip off the jack and hurt someone near it. Raise the vehicle only enough to remove the tire.

6. Remove the lug nuts and wheel.
7. Mount the spare tire on the axle.
8. Install the lug nuts with the cone-shaped end toward the wheel. Lightly tighten the lug nuts clockwise.

### WARNING!

To avoid the risk of forcing the vehicle off the jack, do not tighten the wheel nuts fully until the vehicle has been lowered. Failure to follow this warning may result in serious injury.

9. Lower the vehicle by turning the jack screw to the counterclockwise, and remove the jack.
10. Finish tightening the wheel bolts. Push down on the wrench while at the end of the handle for increased leverage. Tighten the wheel bolts in a star pattern until each wheel bolt has been tightened twice. If in doubt about the correct tightness, have them checked with a torque wrench by an authorized dealer or at a service station.
11. After 25 miles (40 km), check the lug nut torque with a torque wrench to ensure that all lug nuts are properly seated against the wheel.
12. Remove the jack assembly and wheel blocks.
13. Secure the jack and tools in their proper locations.
14. Secure the damaged wheel/tire on the spare tire carrier. Torque down lug nuts and locking lug nut.

15. Return the lock bolt to the lock position on the camera cover by turning the lock clockwise using the provided #40 torx head driver and ratchet. Then, reinstall the camera cover by slipping it over the camera/tire carrier until it snaps into place.

### WARNING!

A loose tire or jack thrown forward in a collision or hard stop, could endanger the occupants of the vehicle. Always stow the jack parts and the spare tire in the places provided.

## JUMP STARTING— GAS MODELS

If your vehicle has a discharged battery, it can be jump started using a set of jumper cables and a battery in another vehicle, or by using a portable battery booster pack. Jump starting can be dangerous if done improperly, so please follow the procedures in this section carefully.

### WARNING!

Do not attempt jump starting if the battery is frozen. It could rupture or explode and cause personal injury.

### CAUTION!

Do not use a portable battery booster pack or any other booster source with a system voltage greater than 12 Volts or damage to the battery, starter motor, alternator or electrical system may occur.

### NOTE:

When using a portable battery booster pack, follow the manufacturer's operating instructions and precautions.

## PREPARATIONS FOR JUMP STARTING — GAS MODELS

The battery in your vehicle is located in the left rear of the engine compartment.

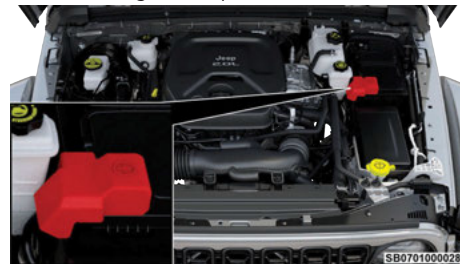

Positive (+) Battery Post Location

See the following steps to prepare for jump starting:

1. Apply the parking brake, shift the automatic transmission into PARK (P) and turn the ignition to OFF.
2. Turn off the heater, radio, and all electrical accessories.
3. Pull upward and remove the protective cover over the positive (+) battery post.
4. If using another vehicle to jump start the battery, park the vehicle within the jumper cables reach, set the parking brake and make sure the ignition is OFF.

#### WARNING!

- Do not allow vehicles to touch each other as this could establish a ground connection and personal injury could result.
- Take care to avoid the radiator cooling fan whenever the hood is raised. It can start anytime the ignition switch is ON. You can be injured by moving fan blades.
- Remove any metal jewelry such as rings, watch bands and bracelets that could make an inadvertent electrical contact. You could be seriously injured.

*(Continued)*

#### WARNING!

- Batteries contain sulfuric acid that can burn your skin or eyes and generate hydrogen gas which is flammable and explosive. Keep open flames or sparks away from the battery.

### JUMP STARTING PROCEDURE — GAS MODELS

#### WARNING!

Failure to follow this jump starting procedure could result in personal injury or property damage due to battery explosion.

#### CAUTION!

Failure to follow these procedures could result in damage to the charging system of the booster vehicle or the discharged vehicle.

#### Connecting The Jumper Cables

1. Connect the positive (+) end of the jumper cable to the positive (+) post of the discharged vehicle.
2. Connect the opposite end of the positive (+) jumper cable to the positive (+) post of the booster battery.

3. Connect the negative (-) end of the jumper cable to the negative (-) post of the booster battery.
4. Connect the opposite end of the negative (-) jumper cable to a good engine ground. A "ground" is an exposed metallic/unpainted part of the engine, frame or chassis, such as an accessory bracket or large bolt. The ground must be away from the battery and the fuel injection system.

#### WARNING!

Do not connect the jumper cable to the negative (-) post of the discharged battery. The resulting electrical spark could cause the battery to explode and could result in personal injury.

5. Start the engine in the vehicle that has the booster battery, let the engine idle for a few minutes, and then start the engine in the vehicle with the discharged battery.
6. Once the engine is started, follow the disconnecting procedure.

#### Disconnecting The Jumper Cables

1. Disconnect the negative (-) end of the jumper cable from the engine ground of the vehicle with the discharged battery.

2. Disconnect the opposite end of the negative (-) jumper cable from the negative (-) post of the booster battery.
3. Disconnect the positive (+) end of the jumper cable from the positive (+) post of the booster battery.
4. Disconnect the opposite end of the positive (+) jumper cable from the positive (+) post of the vehicle with the discharged battery, and reinstall the protective cover.

#### CAUTION!

Accessories plugged into the vehicle power outlets draw power from the vehicle's battery, even when not in use (i.e., cellular devices, etc.). Eventually, if plugged in long enough without engine operation, the vehicle's battery will discharge sufficiently to degrade battery life and/or prevent the engine from starting.

If frequent jump starting is required to start your vehicle, you should have the battery and charging system inspected at an authorized dealer.

## FREEING A STUCK VEHICLE

If your vehicle becomes stuck in mud, sand or snow, it can often be moved using a rocking

motion. Turn the steering wheel right and left to clear the area around the front wheels. For vehicles with automatic transmission, push and hold the lock button on the gear selector. Then, shift back and forth between DRIVE (D) and REVERSE (R), while gently pressing the accelerator. Use the least amount of accelerator pedal pressure that will maintain the rocking motion, without spinning the wheels or racing the engine.

#### NOTE:

- For vehicles with automatic transmission: Shifts between DRIVE (D) and REVERSE (R) can only be achieved at wheel speeds of 5 mph (8 km/h) or less. Whenever the transmission remains in NEUTRAL (N) for more than two seconds, you must press the brake pedal to engage DRIVE (D) or REVERSE (R).
- Push the ESC OFF button to place the Electronic Stability Control (ESC) system in "Partial OFF" mode, before rocking the vehicle. Once the vehicle has been freed, push the ESC OFF button again to restore "ESC On" mode.

#### WARNING!

Fast spinning tires can be dangerous. Forces generated by excessive wheel speeds may

*(Continued)*

#### WARNING!

cause damage, or even failure, of the axle and tires. A tire could explode and injure someone. Do not spin your vehicle's wheels faster than 30 mph (48 km/h) or for longer than 30 seconds continuously without stopping when you are stuck and do not let anyone near a spinning wheel, no matter what the speed.

#### CAUTION!

- Racing the engine or spinning the wheels may lead to transmission overheating and failure. Allow the engine to idle with the transmission in NEUTRAL for at least one minute after every five rocking-motion cycles. This will minimize overheating and reduce the risk of clutch or transmission failure during prolonged efforts to free a stuck vehicle.
- When "rocking" a stuck vehicle by shifting between DRIVE/FIRST gear and REVERSE, do not spin the wheels faster than 15 mph (24 km/h), or drivetrain damage may result.
- Revving the engine or spinning the wheels too fast may lead to transmission overheating and failure. It can also damage the tires. Do not spin the wheels above 30 mph (48 km/h) while in gear (no transmission shifting occurring).

## TOWING A DISABLED VEHICLE

This section describes procedures for towing a disabled vehicle using a commercial towing service.

If the transmission and drivetrain are operable, disabled 4x4 vehicles may also be towed as described.

Towing Condition	Wheels OFF The Ground	4WD MODELS
Flat Tow	NONE	NOT ALLOWED
Wheel Lift Or Dolly Tow	Front	NOT ALLOWED
	Rear	NOT ALLOWED
Flatbed	ALL	BEST METHOD

### NOTE:

When towing your vehicle, always follow applicable state and provincial laws. Contact state and provincial Highway Safety offices for additional details.

Proper towing or lifting equipment is required to prevent damage to your vehicle. Use only tow bars and other equipment designed for this purpose, following equipment manufacturer's instructions. Use of safety chains is mandatory. Attach a tow bar or other towing device to main

structural members of the vehicle, not to fascia/bumpers or associated brackets. State and local laws regarding vehicles under tow must be observed.

If you must use the accessories (wipers, defrosters, etc.) while being towed, the ignition must be in the ON/RUN position, not the ACC position.

If the vehicle's battery is discharged, instructions on shifting the automatic transmission out of PARK (P) in order to move the vehicle.

### CAUTION!

- Do not use sling type equipment when towing. Vehicle damage may occur.
- When securing the vehicle to a flatbed truck, do not attach to front or rear suspension components. Damage to your vehicle may result from improper towing.
- If the vehicle being towed requires steering, the ignition switch must be in the ACC or ON/RUN mode, not in the OFF mode.

## TOWING IN AN EMERGENCY

### Without The Key Fob

Special care must be taken when the vehicle is towed with the ignition in the OFF mode. The only approved method of towing without the

key fob is with a flatbed truck. Proper towing equipment is necessary to prevent damage to the vehicle.

### Manual Park Release

In order to move the vehicle in cases where the transmission will not shift out of PARK (P) (such as a depleted battery), a Manual Park Release is available.

### WARNING!

Always secure your vehicle by fully applying the parking brake before activating the Manual Park Release. In addition, you should be seated in the driver's seat with your foot firmly on the brake pedal when activating the Manual Park Release. Activating the Manual Park Release will allow your vehicle to roll away if it is not secured by the parking brake, or by proper connection to a tow vehicle. Activating the Manual Park Release on an unsecured vehicle could lead to serious injury or death for those in or around the vehicle.

See the following steps to use the Manual Park Release:

1. Firmly apply the parking brake.
2. Using a small screwdriver or similar tool, remove the manual park release cover located in front of the gear selector, to access the release tether strap.

3. Fish the tether strap up through the opening in the console base.
4. Press and maintain firm pressure on the brake pedal.
5. Pull the tether strap up until the release lever locks into place in the vertical position. The vehicle is now out of PARK (P) and can be moved. Release the parking brake only when the vehicle is securely connected to a tow vehicle.



**Vertical Released Position**

#### To Reset The Manual Park Release:

1. Pull upward on the tether strap, releasing it from the “locked” position.
2. Lower the Manual Park Release lever downward and to the left, into its original position.

3. Tuck the tether strap into the base of the console, and reinstall the cover.

#### **NOTE:**

When the lever is locked in the release position the access cover cannot be reinstalled.

#### **Emergency Tow Hooks — If Equipped**

If your vehicle is equipped with tow hooks, they are mounted in the front and the rear fascia/bumpers.

#### **NOTE:**

For off-road recovery, it is recommended to use both of the front tow hooks to minimize the risk of damage to the vehicle. Always use an appropriately rated tow strap.



**Front Tow Hook**



**Rear Tow Hook**

#### **WARNING!**

- Do not use a chain for freeing a stuck vehicle. Chains may break, causing serious injury or death.
- Stand clear of vehicles when pulling with tow hooks. Tow straps may become disengaged, causing serious injury.

#### **CAUTION!**

- Tow hooks are for emergency use only, to rescue a vehicle stranded off road. Tow straps are recommended when towing the vehicle, chains may cause vehicle damage.

*(Continued)*



#### CAUTION!

- The tow hooks must not be used to move the vehicle off the road or where there are obstacles.
- Do not use the tow hooks for tow truck hookup or highway towing.
- Do not use the tow hooks to pull a vehicle onto a flatbed truck.
- Do not use the tow hooks to free a stuck vehicle.
- Damage to your vehicle may occur if these guidelines are not followed.

## ENGINE COMPARTMENT OVERVIEW

### 2.0L ENGINE

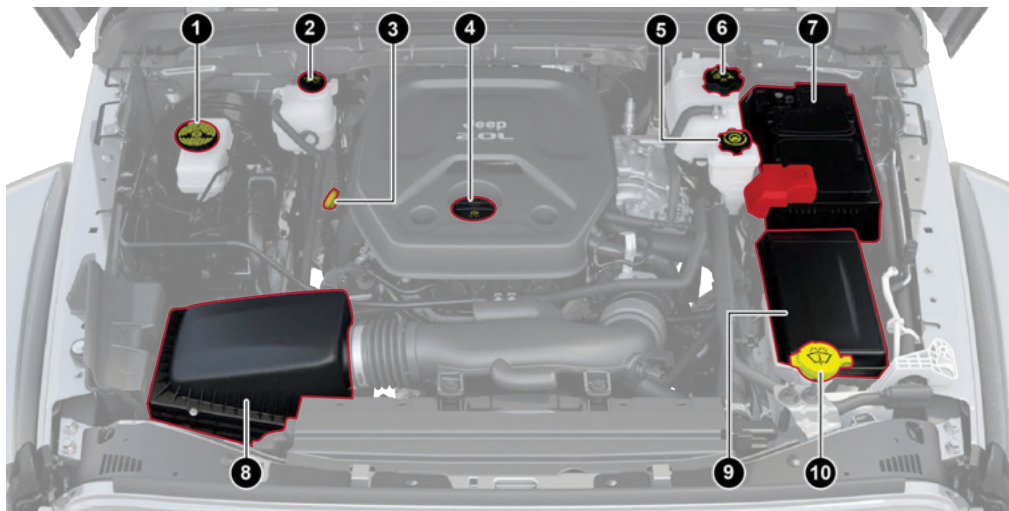

- 1 — Brake Fluid Reservoir Cap
- 2 — Intercooler Coolant Reservoir Cap
- 3 — Engine Oil Dipstick
- 4 — Engine Oil Fill

- 5 — Power Steering Reservoir Cap
- 6 — Engine Coolant Pressure Cap
- 7 — Battery
- 8 — Engine Air Cleaner, Filter

- 9 — Power Distribution Center (Fuses)
- 10 — Washer Fluid Reservoir Cap

## FLUID CAPACITIES

	US	Metric
<b>Fuel (Approximate)</b>		
Two Door Models	17.5 gal	66 L
Four Door Models	21.5 gal	81 L
<b>Engine Oil with Filter</b>		
2.0L Engine	5 qt	4.73 L
<b>Cooling System (Includes coolant recovery bottle filled to MAX level)</b>		
2.0L Engine	12 qt	11.4 L
2.0L Engine Intercooler	3.7 qt	3.5 L

## ENGINE FLUIDS AND LUBRICANTS

Component	Fluid, Lubricant, or Genuine Part
Engine Coolant	We recommend using Mopar® Antifreeze/Coolant 10 Year/150,000 Mile (240,000 km) Formula OAT (Organic Additive Technology) or equivalent meeting the requirements of the manufacturer Material Standard MS.90032.

Component	Fluid, Lubricant, or Genuine Part
Engine Oil — 2.0L Engine	We recommend using Mopar® API SP/GF-6A Certified SAE 5W-30 Full Synthetic Engine Oil which meets the requirements of the manufacturer Material Standard MS-13340. Equivalent full synthetic 5W-30 API SP engine oil can be used but must have the API Donut trademark.
	<b>CAUTION!</b>
	<b>Failure to use the recommended API SP/GF-6A or equivalent oil can cause engine damage not covered by the vehicle warranty.</b>
Fuel Selection — 2.0L Engine	Minimum 95 Research Octane Number (RON).

CAUTION!
<ul style="list-style-type: none"> <li>● Mixing of engine coolant (antifreeze) other than specified Organic Additive Technology (OAT) engine coolant (antifreeze), may result in engine damage and may decrease corrosion protection. Organic Additive Technology (OAT) engine coolant is different and should not be mixed with Hybrid Organic Additive Technology (HOAT) engine coolant (antifreeze) or any “globally compatible” coolant (antifreeze). If a non-OAT engine coolant (antifreeze) is introduced into the cooling system in an emergency, the cooling system will need to be drained, flushed, and refilled with fresh OAT coolant (conforming to MS.90032), by an authorized dealer as soon as possible.</li> <li>● Do not use water alone or alcohol-based engine coolant (antifreeze) products. Do not use additional rust inhibitors or antirust products, as they may not be compatible with the radiator engine coolant (antifreeze) and may plug the radiator.</li> <li>● This vehicle has not been designed for use with Propylene Glycol based engine coolant (antifreeze). Use of Propylene Glycol based engine coolant (antifreeze) is not recommended.</li> </ul>

## CHASSIS FLUIDS AND LUBRICANTS

Component	Fluid, Lubricant, or Genuine Part
Automatic Transmission	Use only Mopar® ZF 8 & 9 Speed ATF Automatic Transmission Fluid or equivalent. Failure to use the correct fluid may affect the function or performance of your transmission.
Transfer Case	We recommend using Mopar® ATF+4 Automatic Transmission Fluid.
Front Axle Differential	We recommend using Mopar® Gear & Axle Lubricant (SAE 75W85)(API GL-5).
Rear Axle Differential (M200)	We recommend using Mopar® Gear & Axle Lubricant (SAE 75W140)(API GL-5).
Rear Axle Differential (M220)	We recommend using Mopar® Gear & Axle Lubricant (SAE 75W85)(API GL-5). Models equipped with Trac-Lok Limited Slip Differential require a friction modifier additive.
Brake Master Cylinder	We recommend using Mopar® DOT 3 Brake Fluid, SAE J1703.
Power Steering Reservoir	We recommend using Mopar® Electric Steering Pump Fluid.

## SERVICING AND MAINTENANCE

### SCHEDULED SERVICING

Refer to the "Service And Warranty Handbook" for scheduled servicing.

### OIL CHANGE RESET

- Your vehicle is equipped with an engine oil change indicator system. The change oil message will display in the instrument cluster display for five seconds after a single chime has sounded, to indicate the next scheduled oil change. The engine oil change indicator system is duty cycle based, which means the engine oil change interval may fluctuate, depending upon your personal driving style.

- Unless reset, this message will continue to display each time the ignition is cycled to the ON/RUN position.

To reset the oil change indicator after performing the scheduled maintenance, refer to the following procedure:

1. Without pressing the brake pedal, push the ENGINE START/STOP button and cycle the

ignition to the ON/RUN position (do not start the engine).

2. Fully press the accelerator pedal, slowly, three times within ten seconds.
3. Cycle the ignition to the OFF position.

**NOTE:**

If the indicator message illuminates when you start the vehicle, the oil change indicator system did not reset. If necessary, repeat this procedure.

## ENGINE BREAK-IN RECOMMENDATIONS

A long break-in period is not required for the engine and drivetrain (transmission and axle) in your vehicle.

Drive moderately during the first 300 miles (500 km). After the initial 60 miles (100 km), speeds up to 50 or 55 mph (80 or 90 km/h) are desirable.

While cruising, brief full-throttle acceleration within the limits of local traffic laws contributes to a good break-in. You should avoid wide-open throttle acceleration in low gear as it can be detrimental.

The engine oil installed in the engine at the factory is a high-quality energy conserving type lubricant. Oil changes should be consistent with anticipated climate conditions under which vehicle operations will occur. For the

recommended viscosity and quality grades ⇨ page 45.

### CAUTION!

Never use Non-Detergent Oil or Straight Mineral Oil in the engine or damage may result.

## TRAILER TOWING

In this section you will find safety tips and information on limits to the type of towing you can reasonably do with your vehicle. Before towing a trailer, carefully review this information to tow your load as efficiently and safely as possible.

To maintain the New Vehicle Limited Warranty coverage, follow the requirements and recommendations in this manual concerning vehicles used for trailer towing.

### TRAILER TOWING WEIGHTS (MAXIMUM TRAILER WEIGHT RATINGS)

For trailer towing information (maximum trailer weight ratings) refer to the following website address: <https://www.jeep.com.au/wrangler-jl.html>

## A

Adaptive Cruise Control (ACC) (Cruise Control) .....	22
Air Conditioning .....	17
Android Auto .....	12
Antifreeze (Engine Coolant) .....	45
Automatic Headlights .....	21
Automatic High Beams .....	21
Automatic Temperature Control (ATC) ....	18
Automatic Transmission Fluid Type .....	45
Axle Fluid .....	47
Axle Lock .....	25, 26

## B

Back Up Camera .....	30
Brake Fluid .....	45, 47

## C

Camera .....	30
Camera, Rear .....	30
Capacities, Fuel .....	45
Caps, Filler Fuel .....	31
Oil (Engine) .....	44
Climate Control .....	17

Automatic .....	17
Cooling System Cooling Capacity .....	45
Selection Of Coolant (Antifreeze) .....	45
Cruise Control (Speed Control) .....	22
Customer Assistance .....	5

## D

Defroster, Windshield .....	17
Dimmer Control Switch .....	20

## E

Electrical Power Outlets .....	13
Emergency In Case Of .....	33
SOS Emergency Call .....	33
Emergency, In Case Of Jump Starting .....	38
Engine .....	44
Break-In Recommendations .....	48
Coolant (Antifreeze) .....	45
Fuel Requirements .....	45
Jump Starting .....	38
Oil .....	45
Oil Filler Cap .....	44
Oil Selection .....	45
Engine Overview .....	44

Exterior Lights .....	20
-----------------------	----

## F

Filters Engine Oil .....	45
Fluid Capacities .....	45
Fluid, Brake .....	45
Fog Lights .....	20
Freeing A Stuck Vehicle .....	40
Fuel Filler Cap (Gas Cap) .....	31
Octane Rating .....	45
Requirements .....	45
Tank Capacity .....	45

## G

Gas Cap (Fuel Filler Cap) .....	31
---------------------------------	----

## H

Headlights Switch .....	20
----------------------------	----

## I

Instrument Cluster .....	15
Descriptions .....	15

Inverter	
Power .....	14

## J

Jack Location .....	36
Jack Operation .....	36
Jacking Instructions .....	36
Jump Starting .....	38

## K

Keyless Enter'n Go™ .....	10
---------------------------	----

## L

Lights	
Exterior .....	20
Fog .....	20
Headlights .....	20, 21
Locking	
Axle .....	25, 26

## M

Maintenance Schedule .....	47
Manual	
Park Release .....	41
Media Hub .....	14
MP3 Control .....	14

## N

New Vehicle Break-In Period .....	48
-----------------------------------	----

## O

Oil Change Indicator	
Reset .....	47
Oil, Engine .....	45
Capacity .....	45
Filter .....	45
Recommendation .....	45
Viscosity .....	45

## P

Passive Entry .....	10
Power	
Inverter .....	14
Outlet (Auxiliary Electrical Outlet) .....	13
Seats .....	18

## R

Radio	
Settings .....	11
Rear ParkSense System .....	24
Roadside Assistance .....	33

## S

Schedule, Maintenance .....	47
Seats	
Power .....	18
Second Row USB .....	14
Selection Of Coolant (Antifreeze) .....	45
Service Assistance .....	5
Spare Tires .....	36
Speed Control (Cruise Control) .....	22
Steering	
Wheel, Voice Recognition .....	12
Stop/Start .....	10
Stuck, Freeing .....	40
Sway Bar Disconnect	
Electronic .....	27

## T

Temperature Control, Automatic (ATC) ...	18
Tires	
Spare Tires .....	36
To Open Hood .....	30
Tow Hooks	
Emergency .....	42
Towing .....	41, 48
Disabled Vehicle .....	41
Weight .....	48



Trac-Lok	
Rear Axle .....	24
Trailer Towing .....	48
Trailer And Tongue Weight .....	48
Trailer Towing Guide .....	48
Trailer Weight .....	48
Transfer Case	
Fluid .....	47
Transmission	
Fluid .....	45, 47

## U

Uconnect	
Uconnect Settings .....	11
Uconnect Phone .....	11
Pair (Link) Uconnect Phone To A	
Mobile Phone .....	11
Uconnect System .....	11
USB .....	14

## V

Vehicle Settings .....	11
Voice Command .....	12
Voice Recognition System (VR) .....	12

## W

Warning Lights And Messages .....	16
Windshield Washers .....	21
Windshield Wipers .....	21

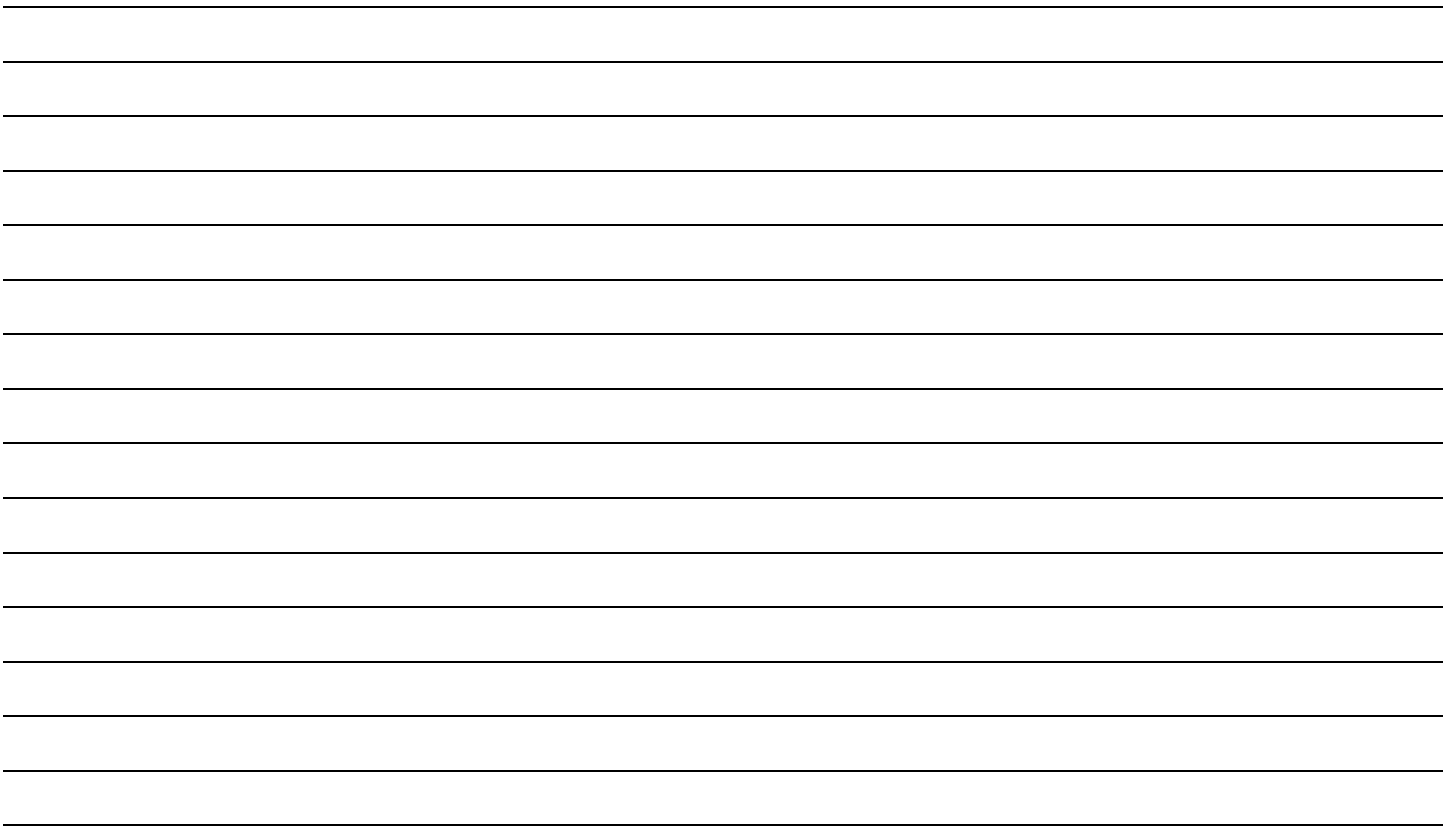

Be sure to follow all instructions in owner's manual for removal of top, doors and lowering of windshield. Driving with the doors off and windshield down is for off-road use only. FCA US LLC strongly recommends that the driver use extreme caution when using any device or feature that may take their attention off the road.



